

LARGE SPACES

VENUES WITH A POTENTIAL SEATING CAPACITY OF 40-144

ROOM 101 PARKWAY NORTH



CAPACITY BREAKDOWN

AUDITORIUM	100
CONFERENCE TABLE	--
U-SHAPE	--
CLASSROOM	--
ROUNDS	--

ROOM DESCRIPTION

A student lounge space that sometimes hosts live music, debates and other scheduled events. Room can be set-up as-is, auditorium or a clear space and holds up to 100 people.

LARGE SPACES

VENUES WITH A POTENTIAL SEATING CAPACITY OF 40-144

ROOM 296, 298

AUDITORIUM



ROUNDS



CAPACITY BREAKDOWN

AUDITORIUM	150
CONFERENCE TABLE	48
U-SHAPE	45
CLASSROOM	72
ROUNDS	80

ROOM DESCRIPTION

Rooms with parquet floors and an airwall in between. Floor to ceiling windows overlook a study lounge. A great multi-purpose room.

LARGE SPACES

VENUES WITH A POTENTIAL SEATING CAPACITY OF 40-144

ROOM 327, 328

AUDITORIUM



ROUNDS

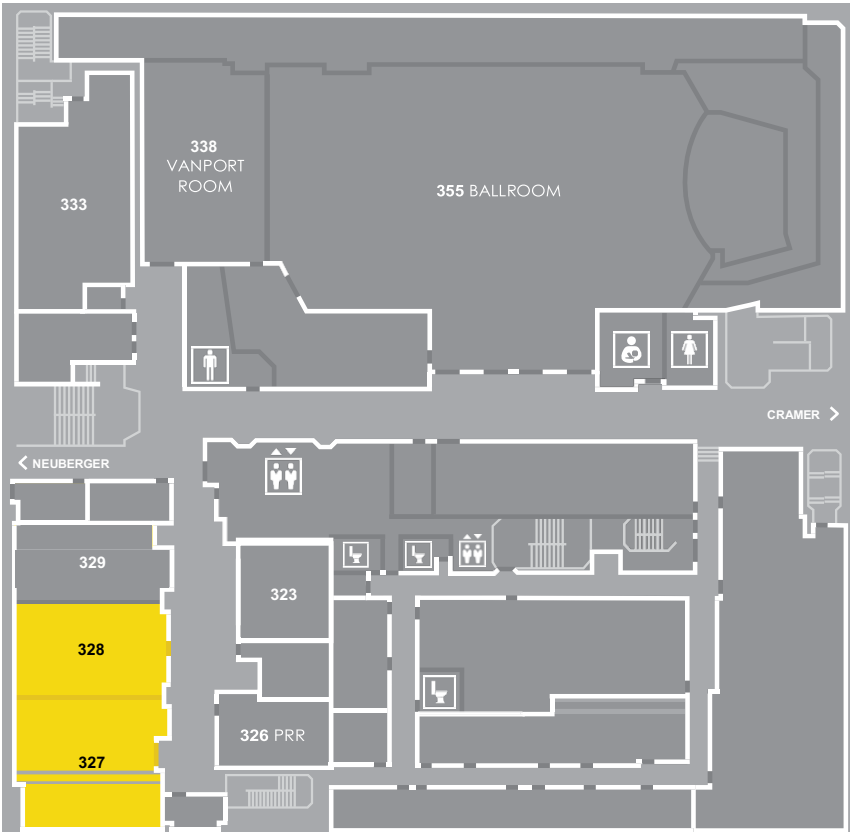

CAPACITY BREAKDOWN

AUDITORIUM	144
CONFERENCE TABLE	--
U-SHAPE	45
CLASSROOM	60
ROUNDS	80

ROOM DESCRIPTION

327, 328 and 329 encompass three disparate, adjoining meeting spaces. Variety is assured when one or both airwalls are opened.

LARGE SPACES

VENUES WITH A POTENTIAL SEATING CAPACITY OF 40-144

ROOM 338 VANPORT

AUDITORIUM

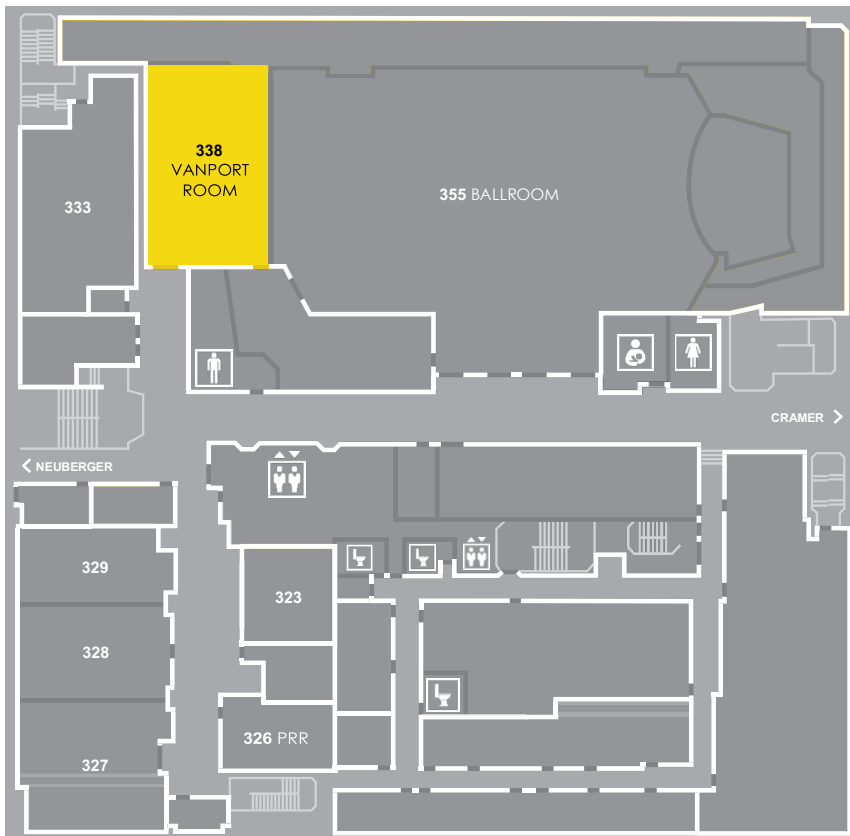

CAPACITY BREAKDOWN

AUDITORIUM	117
CONFERENCE TABLE	--
U-SHAPE	39
CLASSROOM	69
ROUNDS	64

ROOM DESCRIPTION

A large meeting space with hardwood floors. Floor to ceiling windows and adjoining balcony overlooks the South Park Blocks. An airwall separates this space from the Ballroom.