

091-EB

DRAWN BY:
LR
DATE:
7/2015

ENGINEERING BUILDING
AND UNDERGROUND PARKING
BUILDING ACCESS PLAN
1930 SW FOURTH AVENUE

 **Portland State**
UNIVERSITY
Capital Projects and Construction
<http://www.pdx.edu/construction>

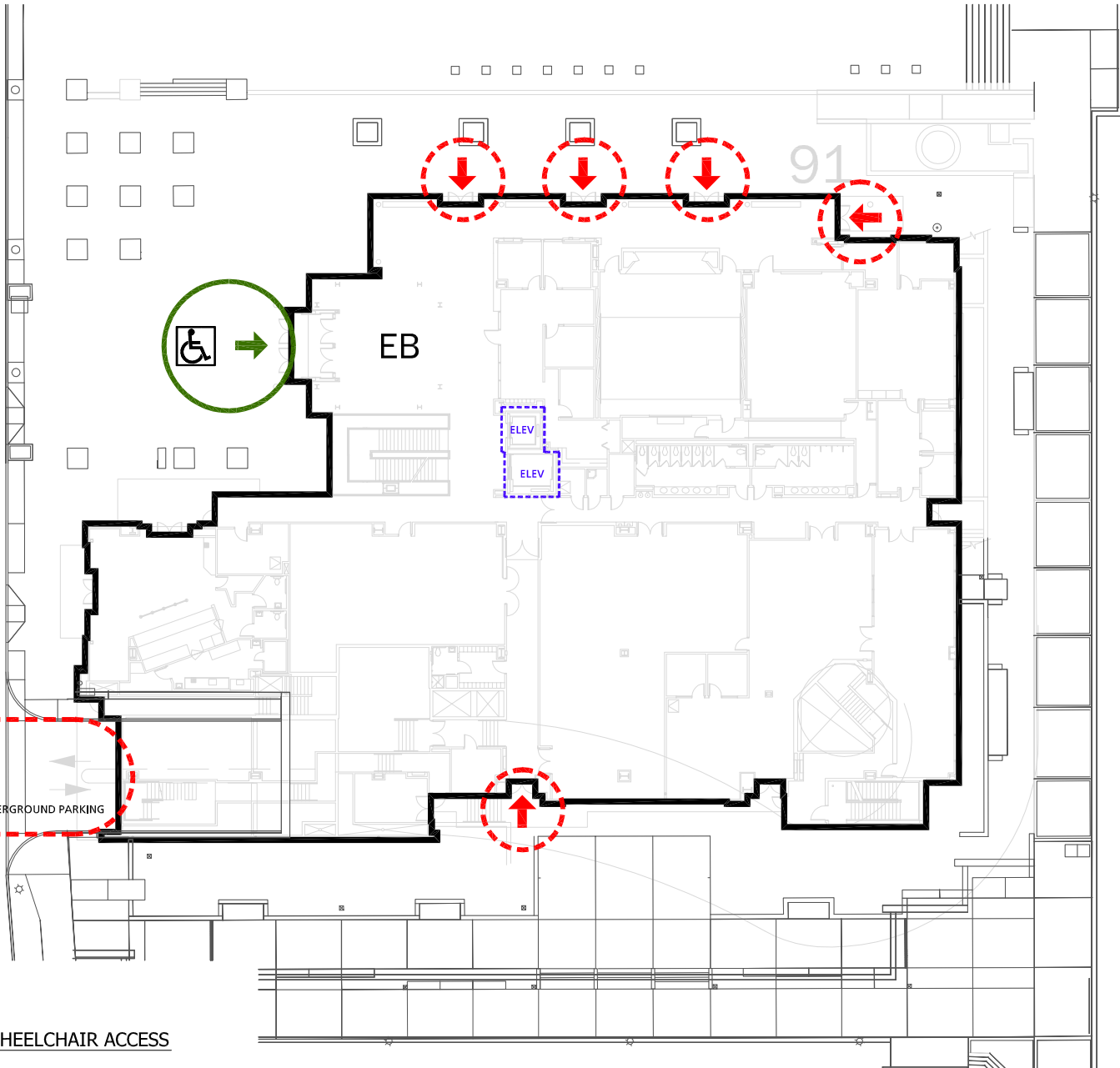

 WHEELCHAIR ACCESS

 BUILDING ACCESS - NOT WHEELCHAIR ACCESSIBLE

If you need assistance, or an accommodation to access an office or classroom please contact:
Disability Resource Center at (503) 725-4150 / **Human Resources** at (503) 725-4926

