

Joseph C. Blumel Bike Garage (BBG)

MAIN ENTRANCE ON FIRST FLOOR

If you need assistance, or an accommodation to access an office or classroom please contact:
For Student - Disability Resource Center at (503) 725-4150
For Employees - Human Resources at (503) 725-4926

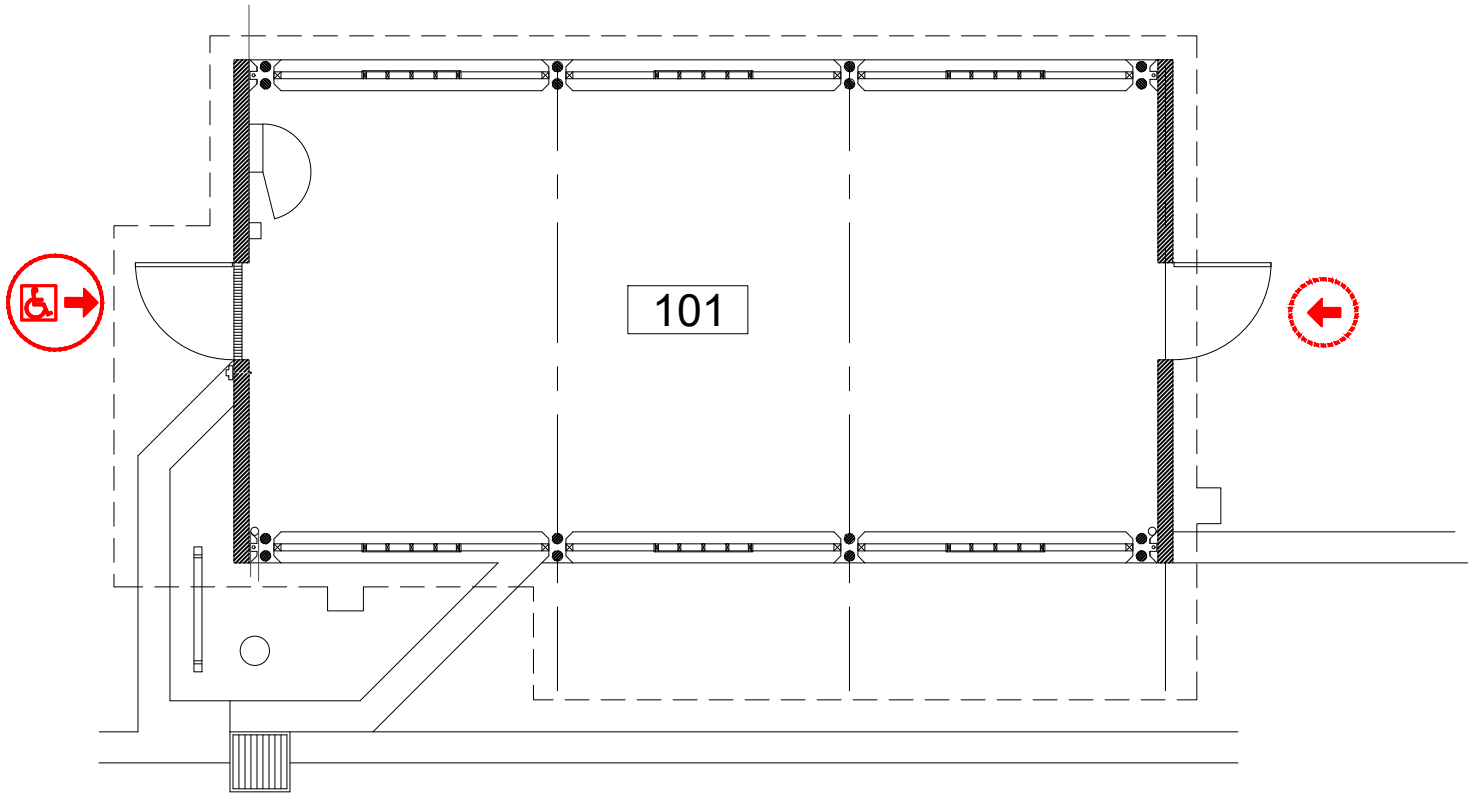

Scale
1/8" = 1'-0"



ELEVATOR ACCESS



WHEELCHAIR ACCESS



BUILDING ACCESS - NOT
WHEELCHAIR ACCESSIBLE



First Floor Plan
Joseph C. Blumel Bike Garage
1705 SW 11th Avenue

DRAWN BY:
ASL
DATE:
08/2020

268_A1