



STANDARD LAYER REPORT			
		AREA	QTY
	Circulation	387	3
	Net Assignable Space	9,847	2
TOTAL:		10,234	5
Floor Gross:		10,797	

STANDARD SPACE REPORT

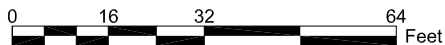

PARKING STRUCTURE TWO

Parking Floor Plan P1

1724 SW Broadway, Portland, Oregon 97201

Print Date: 2010

Last Modified Date: 2010



Portland State
UNIVERSITY

Campus Planning Office
<http://www.pdx.edu/planning-sustainability>

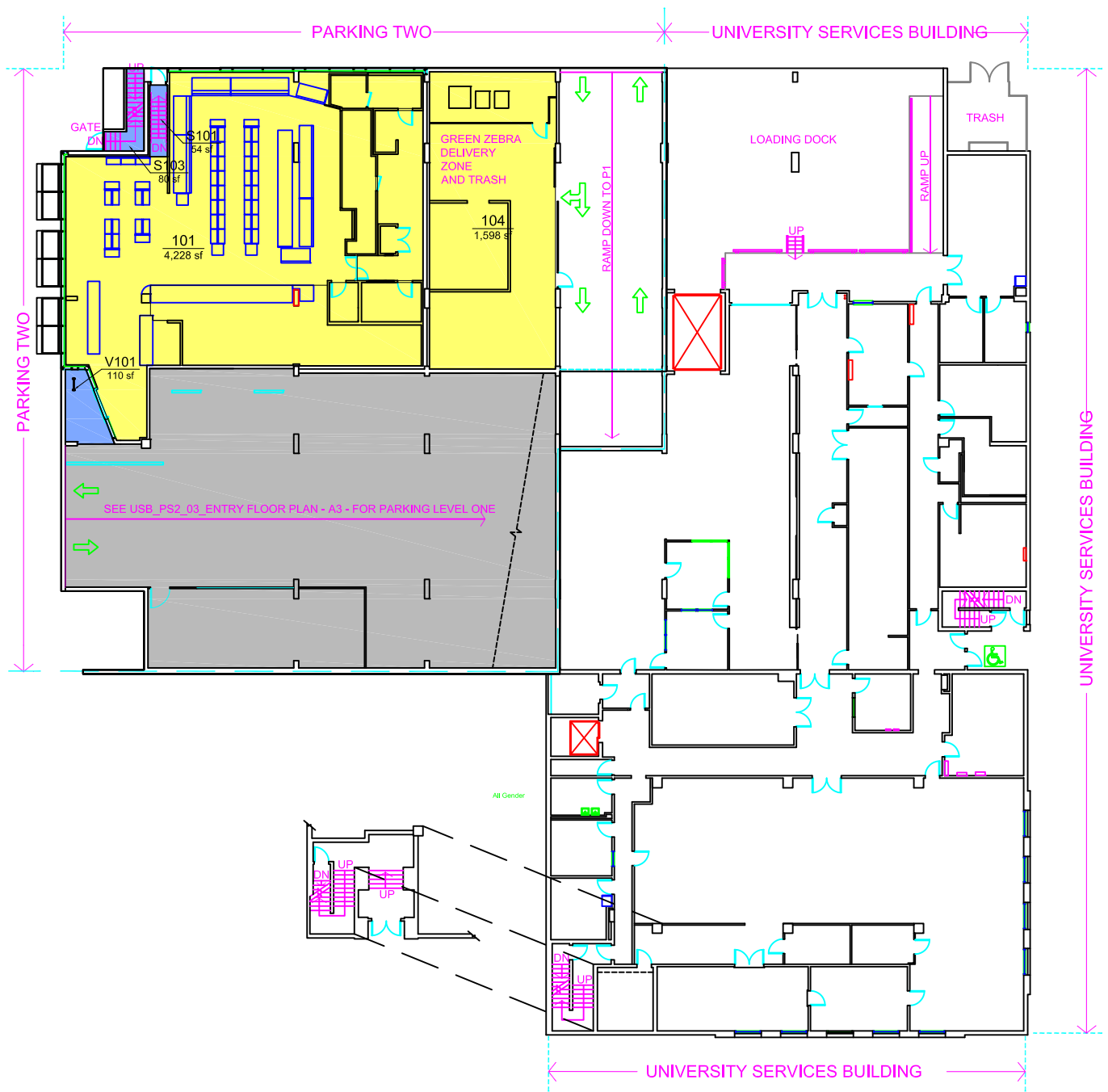

STANDARD LAYER REPORT

	AREA	QTY
 Circulation	244	3
 Net Assignable Space	5,826	2
 Vertical Penetrations	5,639	1
TOTAL:	11,709	6
Floor Gross:	13,771	

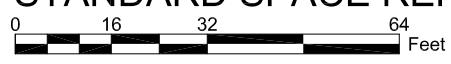

STANDARD SPACE REPORT



PARKING STRUCTURE TWO
Parking Floor Plan P2
 1724 SW Broadway, Portland, Oregon 97201
 Print Date: 2010
 Last Modified Date: 2017

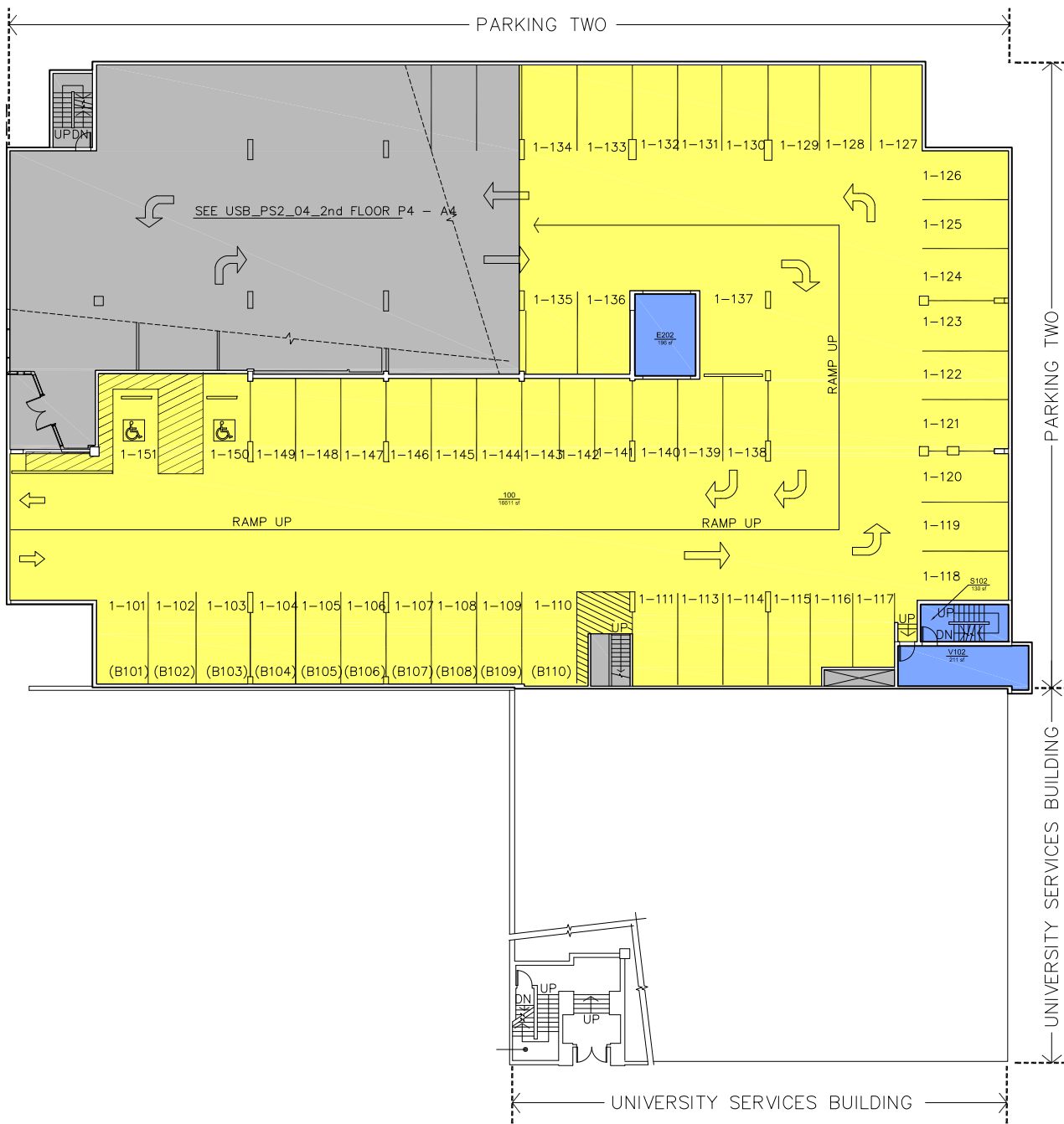

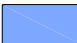

STANDARD LAYER REPORT		
	AREA	QTY
 Circulation	537	3
 Net Assignable Space	16,611	1
 Vertical Penetrations	6,413	4
TOTAL:	23,561	8
Floor Gross:	24,239	

STANDARD SPACE REPORT

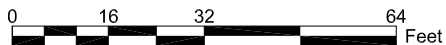

PARKING STRUCTURE TWO

Parking Floor Plan P3

1724 SW Broadway, Portland, Oregon 97201



Print Date: 2010

Last Modified Date: 2010

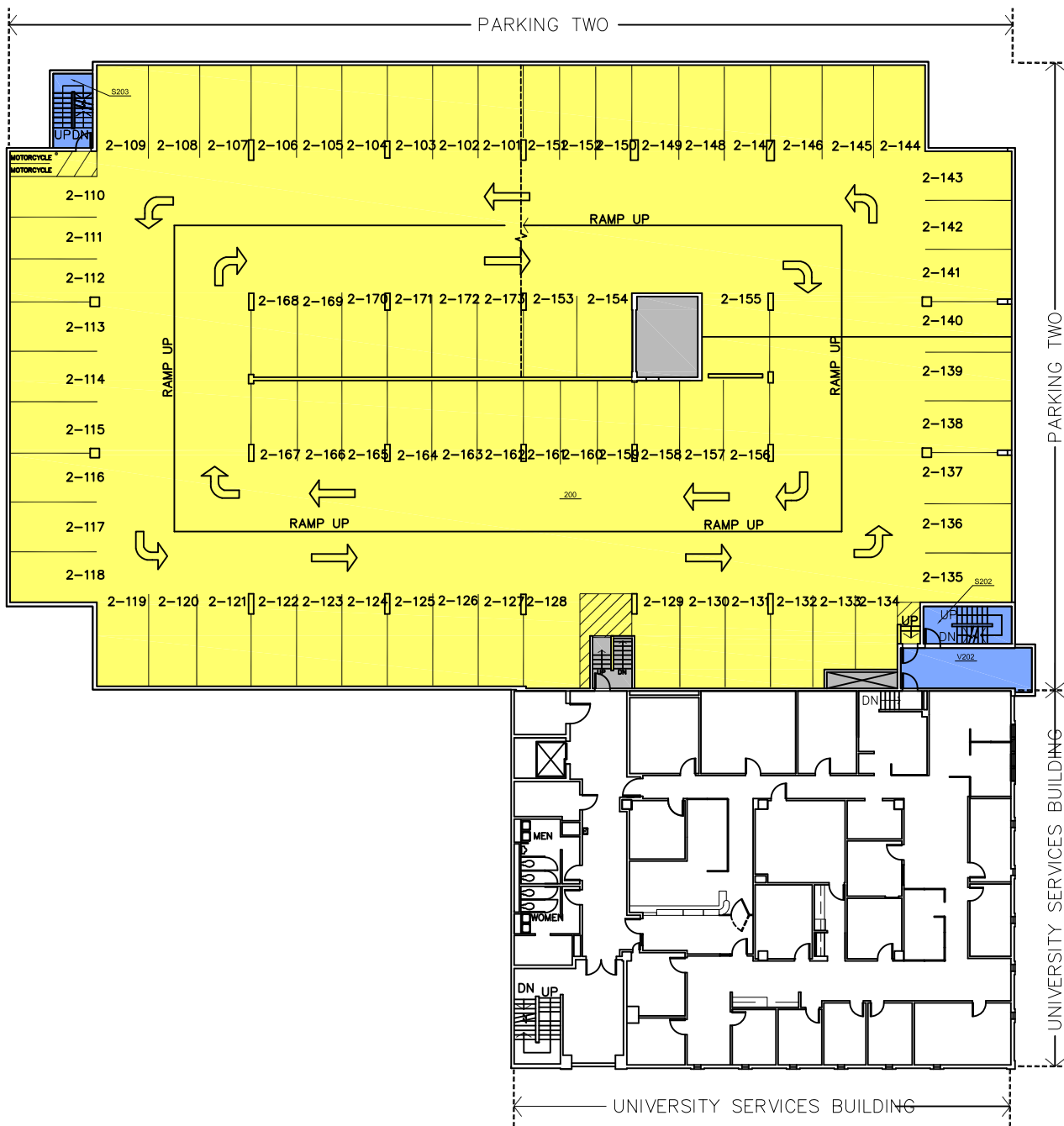

Campus Planning Office
<http://www.pdx.edu/planning-sustainability>

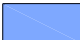

STANDARD LAYER REPORT		
	AREA	QTY
 Circulation	457	3
 Net Assignable Space	22,901	1
 Vertical Penetrations	323	3
TOTAL:	23,681	7
Floor Gross:	24,239	

STANDARD SPACE REPORT

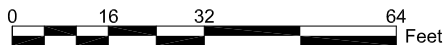

PARKING STRUCTURE TWO

Parking Floor Plan P4

1724 SW Broadway, Portland, Oregon 97201

Print Date: 2010

Last Modified Date: 2010



Campus Planning Office
<http://www.pdx.edu/planning-sustainability>

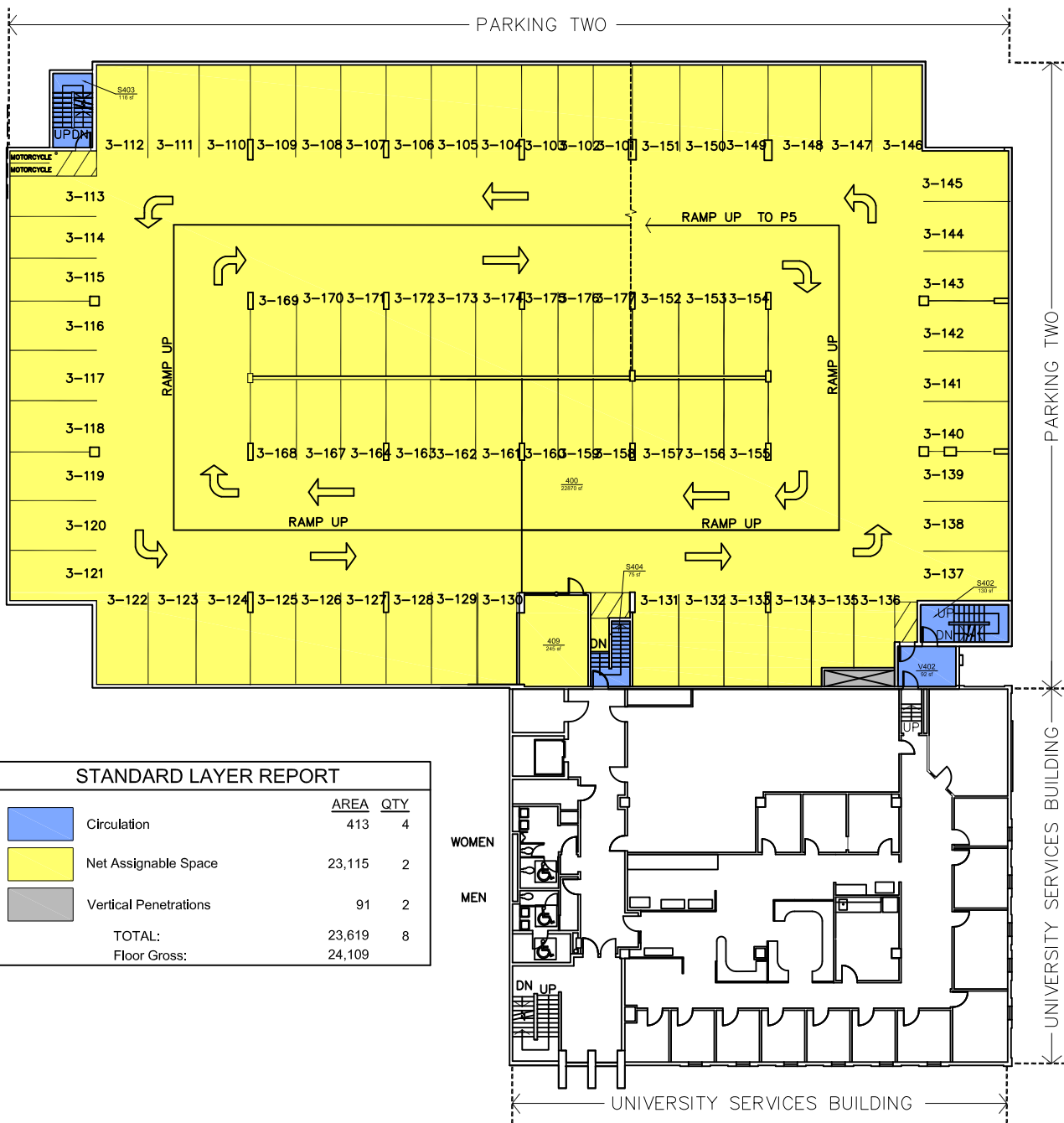

STANDARD SPACE REPORT

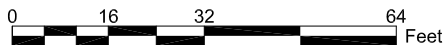

PARKING STRUCTURE TWO

Parking Floor Plan P5

1724 SW Broadway, Portland, Oregon 97201

Print Date: 2010

Last Modified Date: 2010



Campus Planning Office
<http://www.pdx.edu/planning-sustainability>



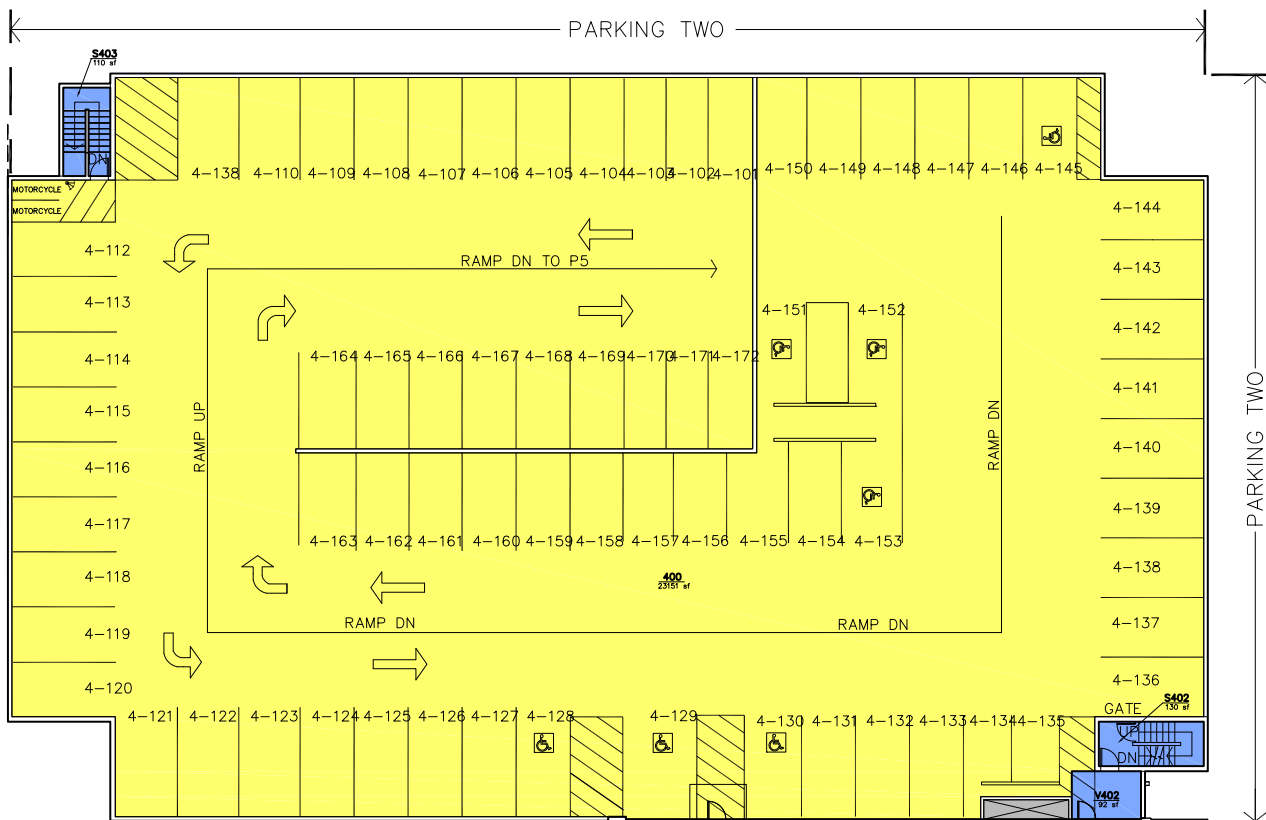

STANDARD LAYER REPORT		
	AREA	QTY
Circulation	332	3
Net Assignable Space	23,151	1
Vertical Penetrations	46	1
TOTAL:	23,529	5
Floor Gross:	24,063	

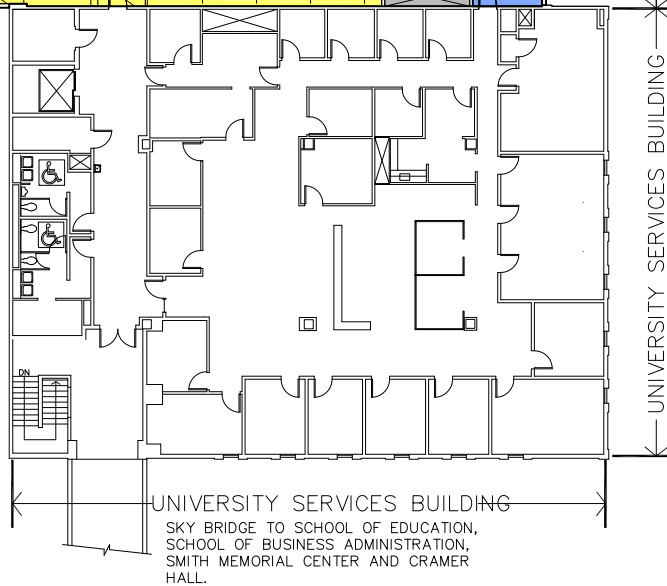

STANDARD SPACE REPORT

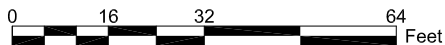

PARKING STRUCTURE TWO

Parking Floor Plan P6

1724 SW Broadway, Portland, Oregon 97201

Print Date: 2010

Last Modified Date: 2010



Campus Planning Office
<http://www.pdx.edu/planning-sustainability>

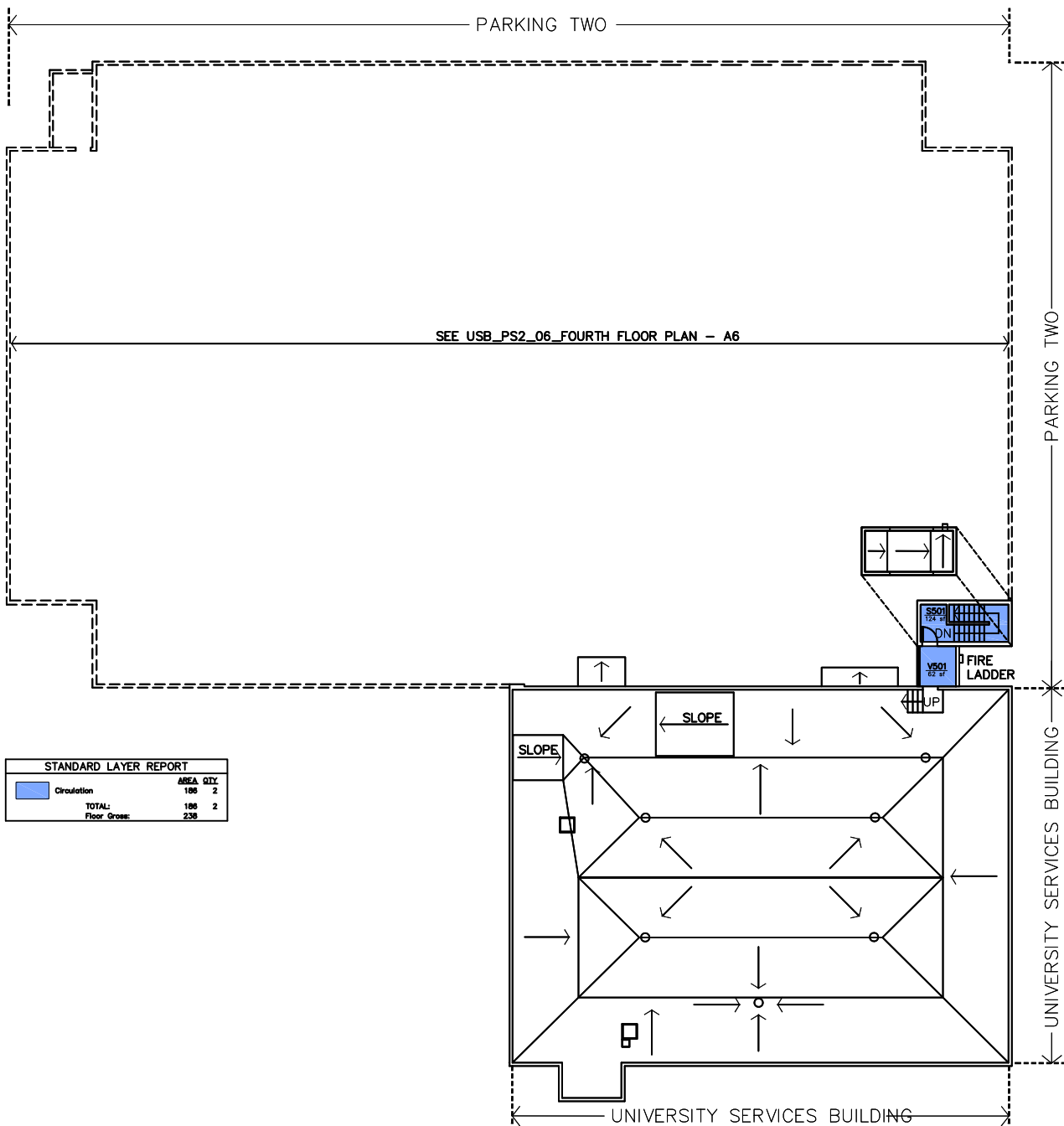

STANDARD SPACE REPORT

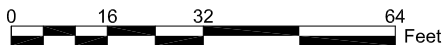

PARKING STRUCTURE TWO

Parking Floor Plan Roof - P6
 1724 SW Broadway, Portland, Oregon 97201
 Print Date: 2010
 Last Modified Date: 2010



Campus Planning Office
<http://www.pdx.edu/planning-sustainability>