

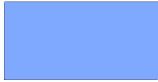

## STANDARD LAYER REPORT

	AREA	QTY
 Building Services	935	7
 Circulation	527	6
 Mechanical Space	683	1
 Net Assignable Space	1,866	3
 Vertical Penetrations	61	7
<b>TOTAL:</b>	<b>4,072</b>	<b>24</b>
<b>Floor Gross:</b>	<b>4,527</b>	

## STANDARD SPACE REPORT

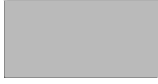
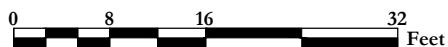

### CAMPUS PUBLIC SAFETY

Basement Floor Plan

633 SW Montgomery Street, Portland, Oregon 97201-5521

Print Date:





Last Modified Date: 06/2018

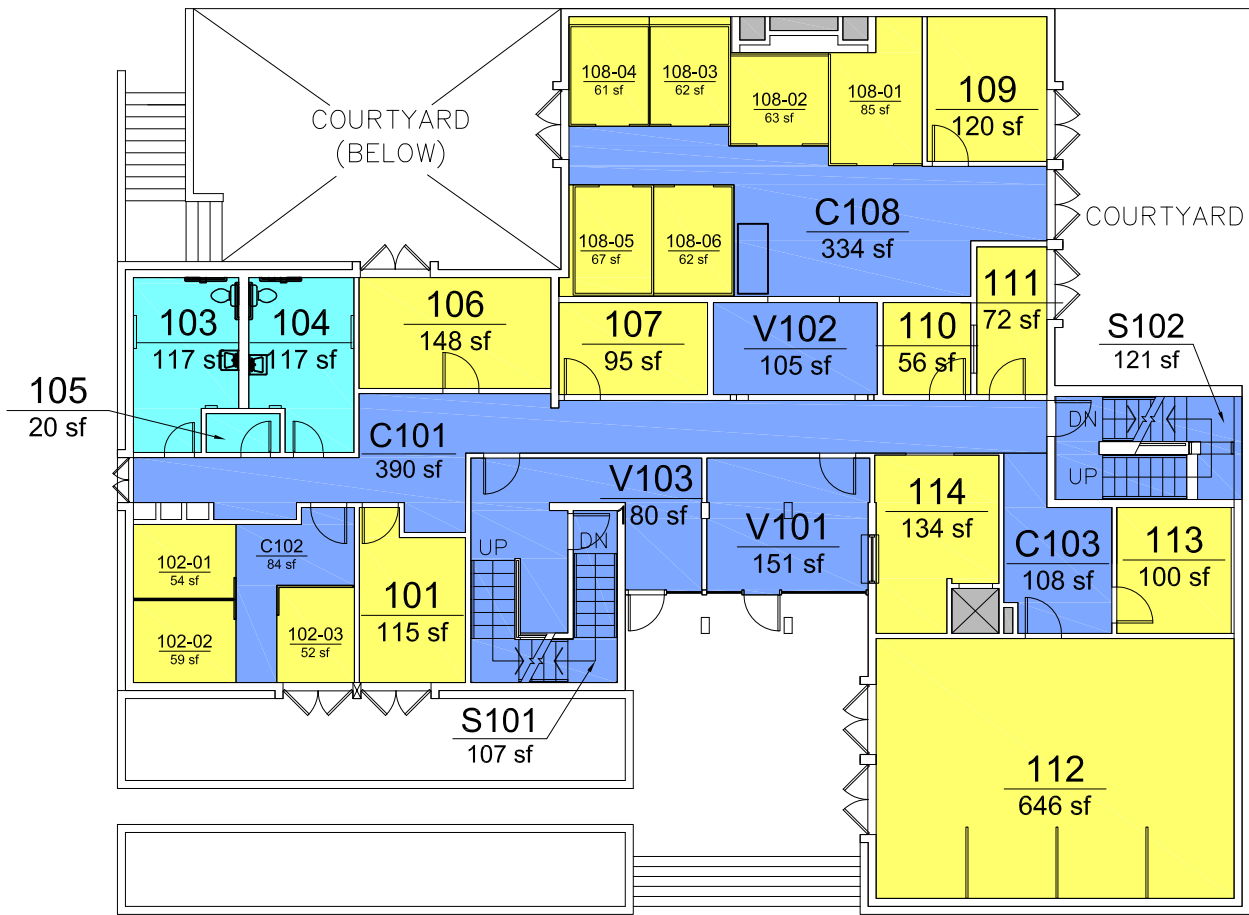

Campus Planning Office  
<http://www.pdx.edu/campus-planning>



## STANDARD LAYER REPORT

	AREA	QTY
 Building Services	254	3
 Circulation	1,580	9
 Net Assignable Space	2,051	18
 Vertical Penetrations	31	5
<b>TOTAL:</b>	<b>3,916</b>	<b>35</b>
<b>Floor Gross:</b>	<b>4,416</b>	

## STANDARD SPACE REPORT

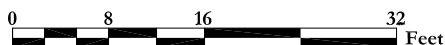

### CAMPUS PUBLIC SAFETY

First Floor

633 SW Montgomery Street, Portland, Oregon 97201-5521

Print Date:

Last Modified Date: 04/2016



Campus Planning Office  
<http://www.pdx.edu/campus-planning>

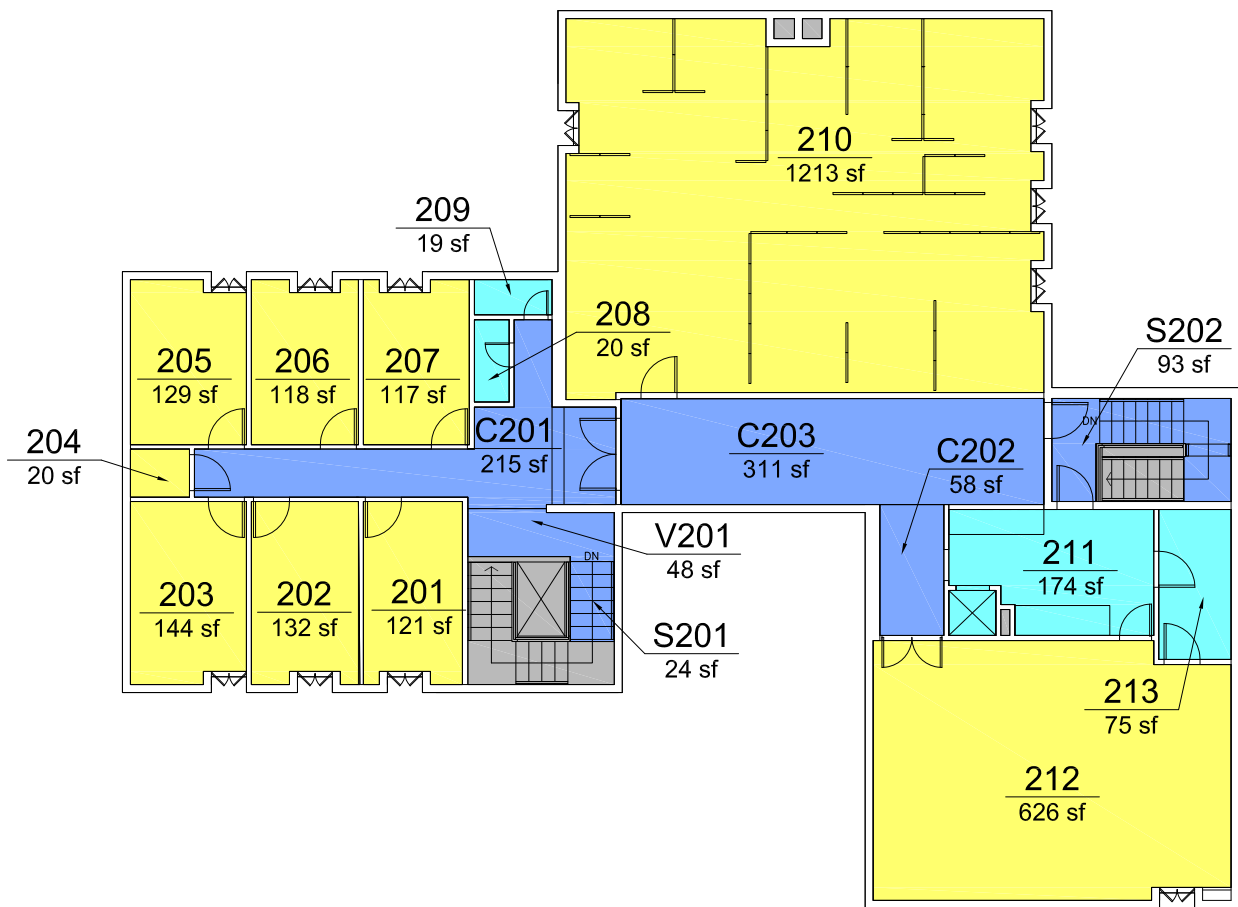

### STANDARD LAYER REPORT

	AREA	QTY
Building Services	288	4
Circulation	749	6
Net Assignable Space	2,620	9
Vertical Penetrations	147	5
<b>TOTAL:</b>	<b>3,804</b>	<b>24</b>
<b>Floor Gross:</b>	<b>4,225</b>	

### STANDARD SPACE REPORT

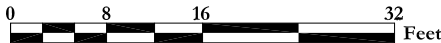

**CAMPUS PUBLIC SAFETY**  
 2nd Floor Plan  
 633 SW Montgomery Street, Portland, Oregon 97201-5521  
 Print Date:  
 Last Modified Date: 04/2016

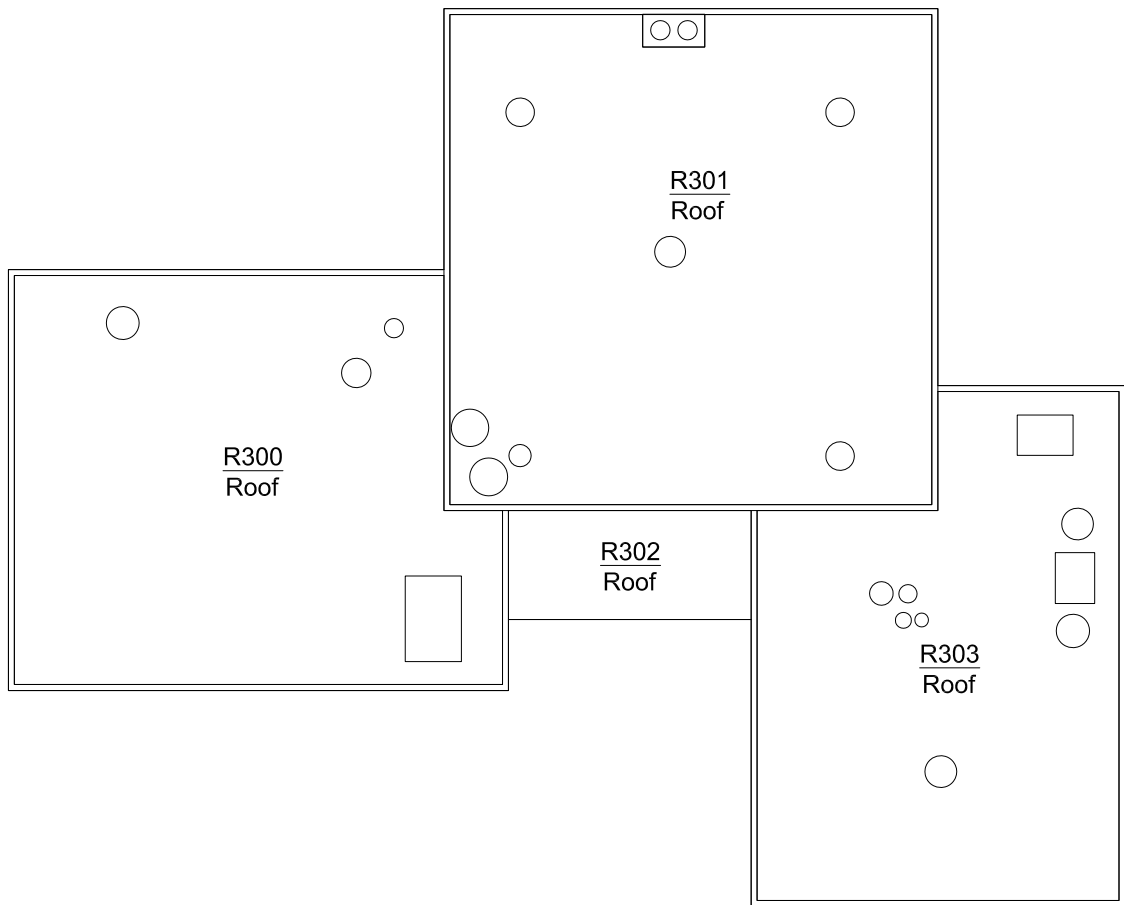

# STANDARD SPACE REPORT

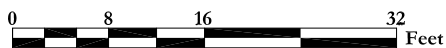

## CAMPUS PUBLIC SAFETY

### Roof Plan

633 SW Montgomery Street, Portland, Oregon 97201-5521

Print Date:

Last Modified Date: 04/2016



Campus Planning Office  
<http://www.pdx.edu/campus-planning>