





STANDARD LAYER REPORT		
	AREA	QTY
 Building Services	383	3
 Circulation	2102	11
 Mechanical Space	6115	12
 Net Assignable Space	15909	8
 Vertical Penetrations	679	15
TOTAL:	25188	49
Floor Gross:	27309	

STANDARD SPACE REPORT

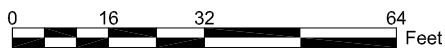

ACADEMIC STUDENT RECREATION CENTER Basement Floor Plan

1800 S. W. 6th Avenue, Portland, Oregon 97201

Print Date: 10/2010

Last Modified Date: 10/2010





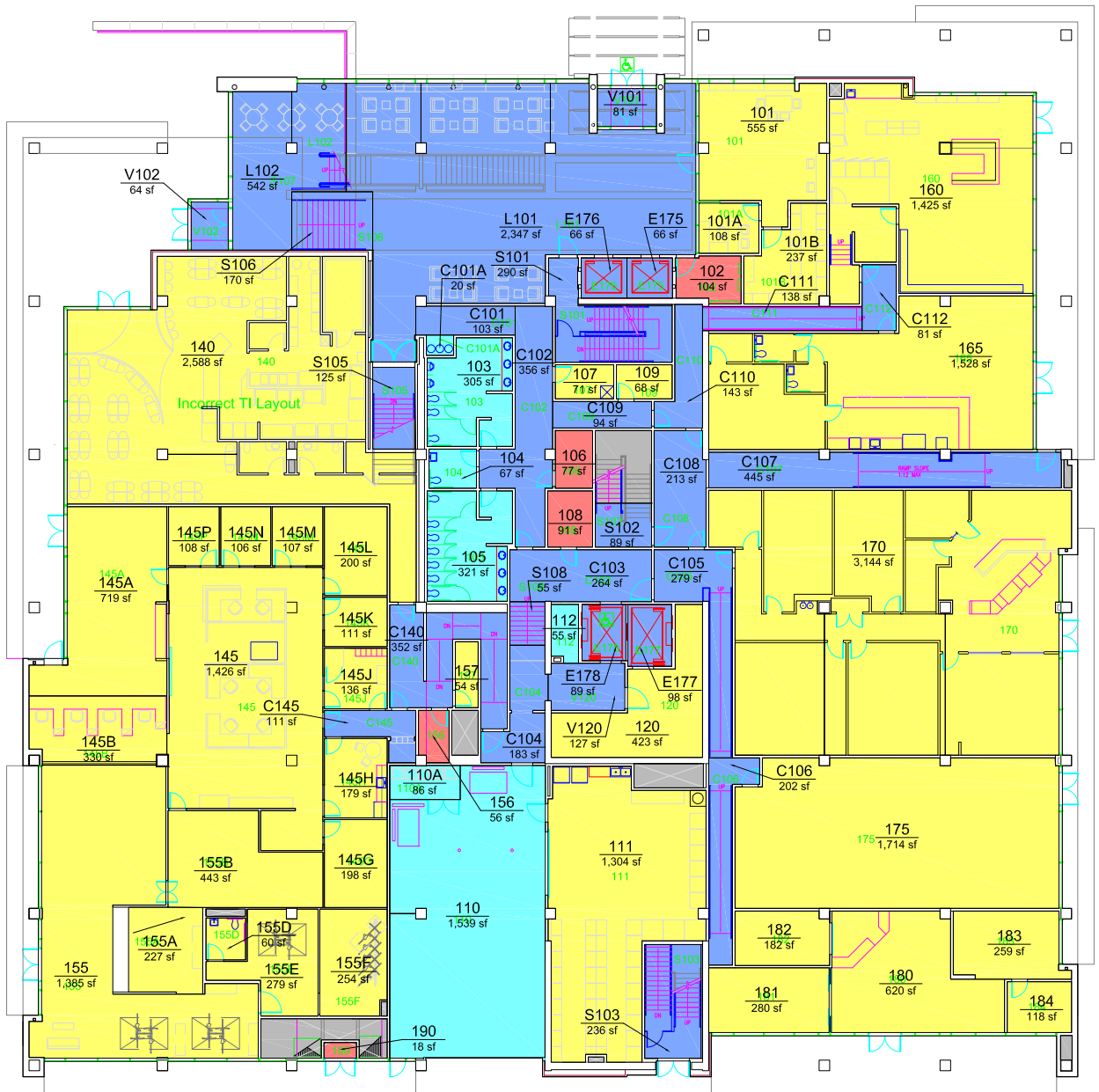

Portland State
UNIVERSITY

Capital Projects and Construction
<http://www.pdx.edu/construction>



STANDARD LAYER REPORT

	AREA	QTY
 Building Services	2,393	7
 Circulation	7,409	29
 Mechanical Space	346	5
 Net Assignable Space	20,946	35
 Vertical Penetrations	447	12
TOTAL:	31,541	88
Floor Gross:	34,053	

STANDARD SPACE REPORT

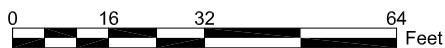

ACADEMIC STUDENT RECREATION CENTER First Floor Plan

1800 S. W. 6th Avenue, Portland, Oregon 97201



Print Date: 10/2010

Last Modified Date: 10/2010

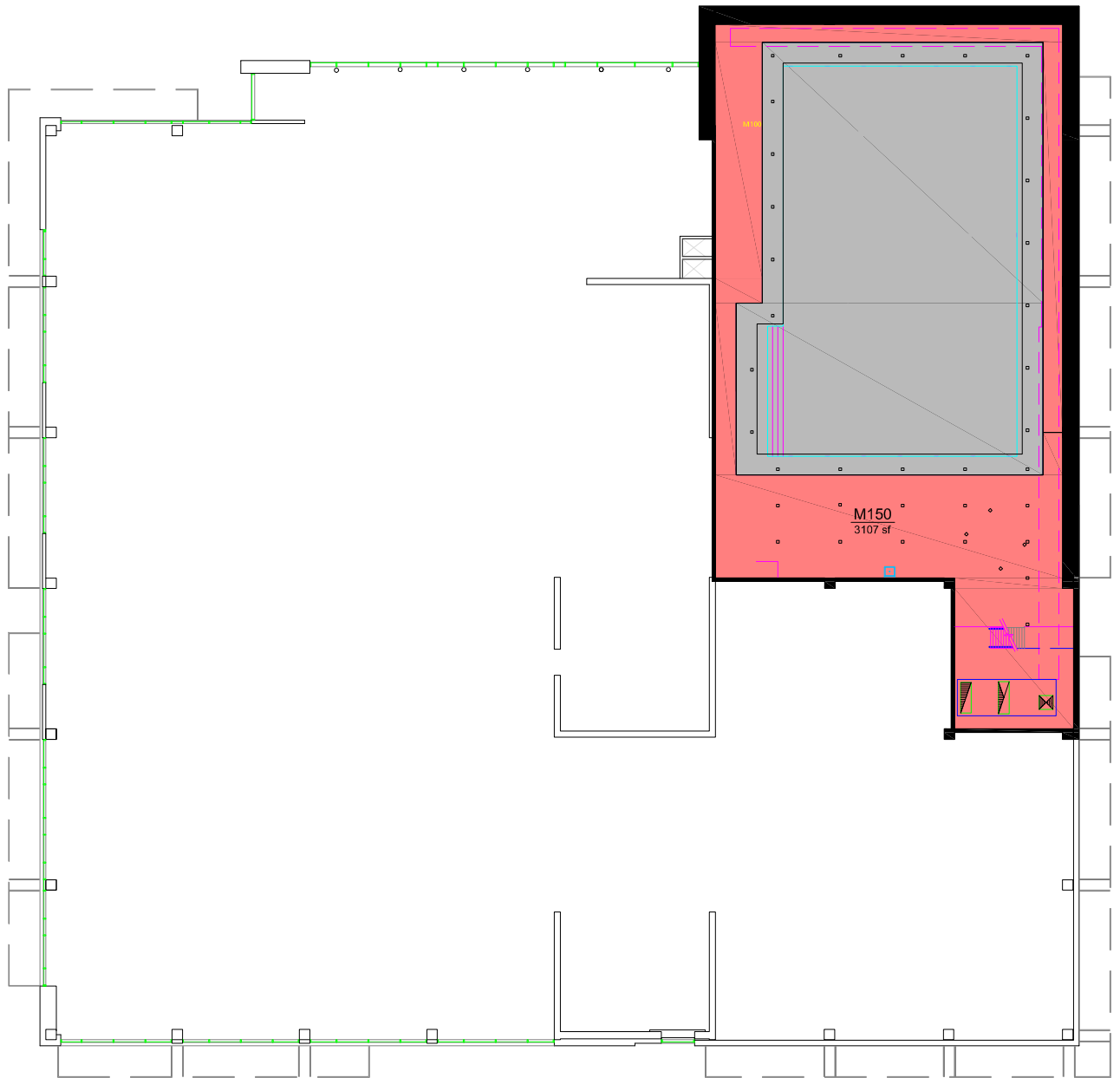

Campus Planning Office
<http://www.pdx.edu/planning-sustainability>





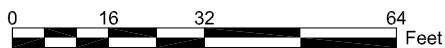



STANDARD LAYER REPORT			
		AREA	QTY
	Mechanical Space	3107	1
	Vertical Penetrations	4656	2
	TOTAL:	7763	3
	Floor Gross:	8594	



ACADEMIC STUDENT RECREATION CENTER
First Floor Mezzanine Plan
 1800 S. W. 6th Avenue, Portland, Oregon 97201
 Print Date: 10/2010
 Last Modified Date: 10/2010





STANDARD LAYER REPORT		
	AREA	QTY
	Building Services	1,309 10
	Circulation	7,588 25
	Mechanical Space	414 5
	Net Assignable Space	23,956 36
	Open To Below	1,589 2
	Vertical Penetrations	388 13
TOTAL:		35,244 91
Floor Gross:		38,009

STANDARD SPACE REPORT

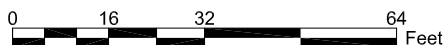

ACADEMIC STUDENT RECREATION CENTER Second Floor Plan

1800 S. W. 6th Avenue, Portland, Oregon 97201

Print Date:

Last Modified Date: 08/2014



Campus Planning Office
<http://www.pdx.edu/planning-sustainability>

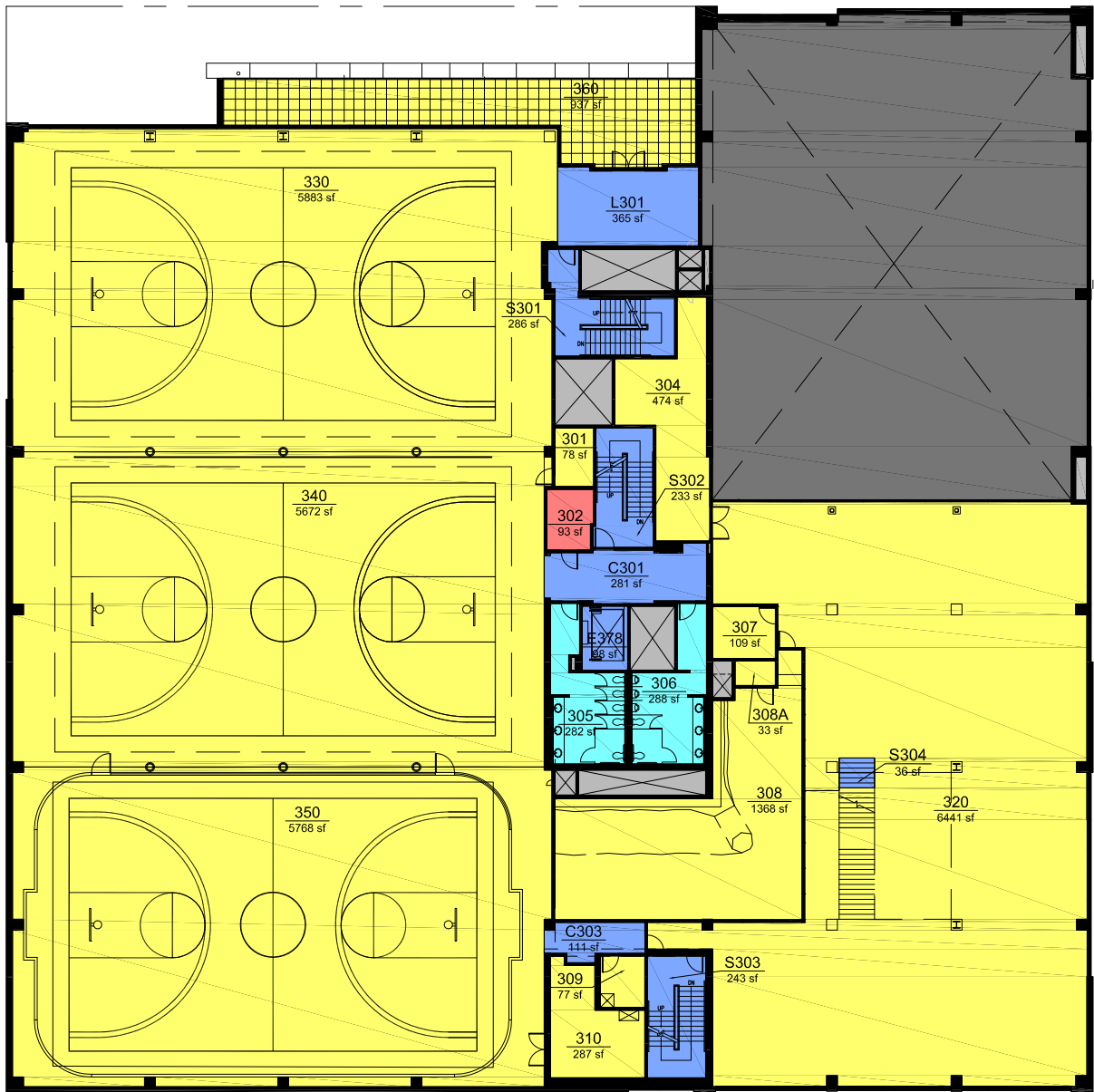

STANDARD LAYER REPORT

	AREA	QTY
Building Services	570	2
Circulation	1,653	8
Mechanical Space	93	1
Net Assignable Space	27,127	12
Open To Below	6,115	1
Vertical Penetrations	582	13
TOTAL:	36,140	37
Floor Gross:	31,660	

STANDARD SPACE REPORT

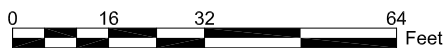

ACADEMIC STUDENT RECREATION CENTER

Third Floor Plan

1800 S. W. 6th Avenue, Portland, Oregon 97201





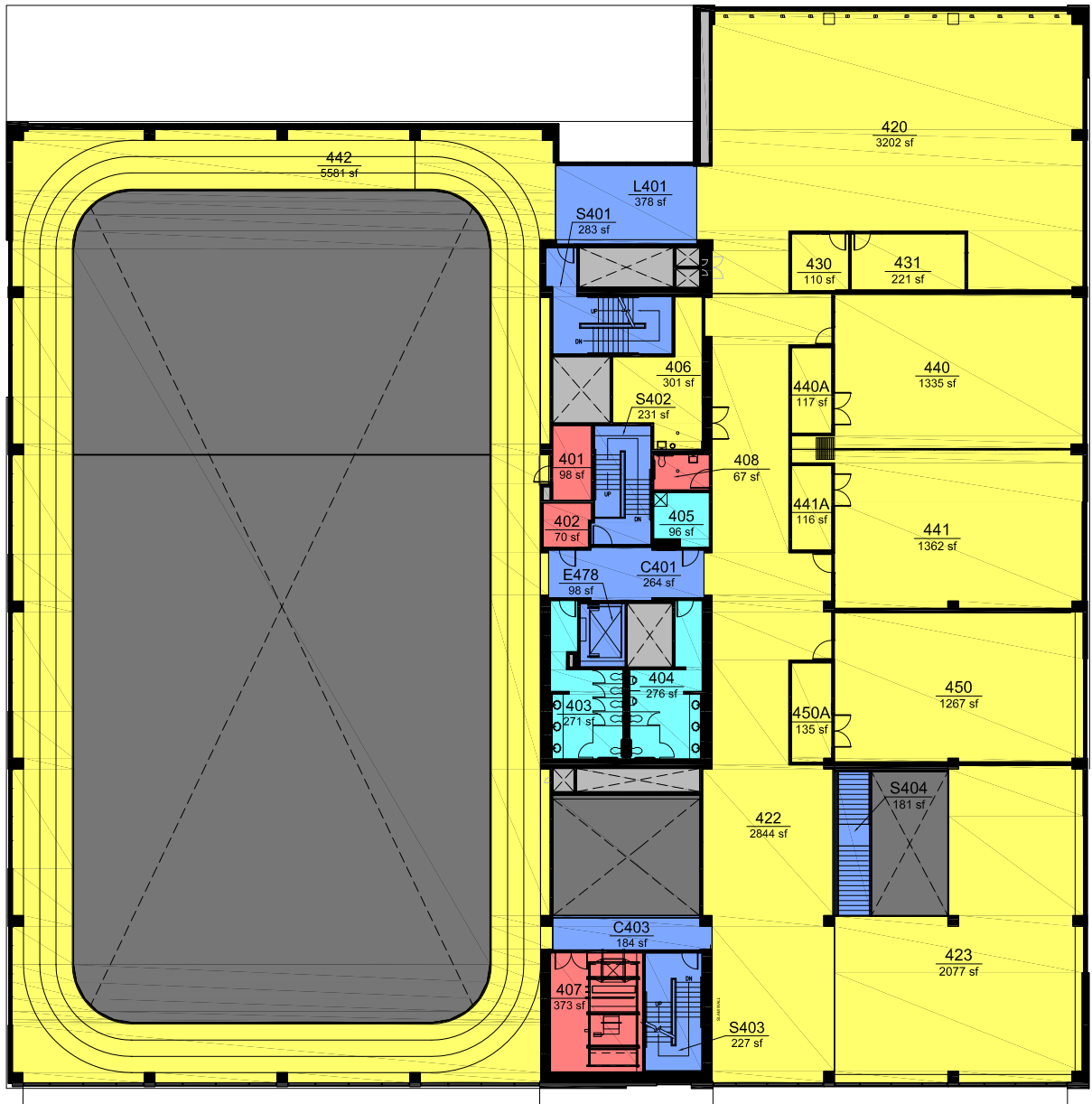

Print Date: 10/2010

Last Modified Date: 10/2010



Campus Planning Office
<http://www.pdx.edu/planning-sustainability>



STANDARD LAYER REPORT			
		AREA	QTY
	Building Services	643	3
	Circulation	1,846	8
	Mechanical Space	608	4
	Net Assignable Space	18,668	13
	Open To Below	12,664	3
	Vertical Penetrations	548	10
TOTAL:		34,977	41
Floor Gross:		24,109	

STANDARD SPACE REPORT

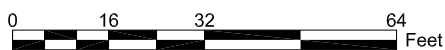

ACADEMIC STUDENT RECREATION CENTER

Fourth Floor Plan

1800 S. W. 6th Avenue, Portland, Oregon 97201

Print Date:

Last Modified Date: 09/2015



Campus Planning Office
<http://www.pdx.edu/planning-sustainability>



STANDARD LAYER REPORT

	AREA	QTY
 Building Services	650	4
 Circulation	5,010	20
 Mechanical Space	306	4
 Net Assignable Space	18,537	40
 Vertical Penetrations	347	15
TOTAL:	24,850	83
Floor Gross:	26,970	

STANDARD SPACE REPORT

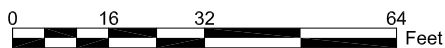

ACADEMIC STUDENT RECREATION CENTER

Fifth Floor Plan

1800 S. W. 6th Avenue, Portland, Oregon 97201





Print Date:

Last Modified Date: 11/2015



Campus Planning Office
<http://www.pdx.edu/planning-sustainability>



STANDARD LAYER REPORT		
	AREA	QTY
	Building Services	161 2
	Circulation	7,231 18
	Mechanical Space	204 3
	Net Assignable Space	16,766 87
	Vertical Penetrations	678 16
TOTAL:		25,040 126
Floor Gross:		27,768

STANDARD SPACE REPORT

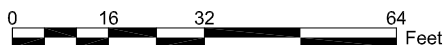





ACADEMIC STUDENT RECREATION CENTER Sixth Floor Plan

1800 S. W. 6th Avenue, Portland, Oregon 97201

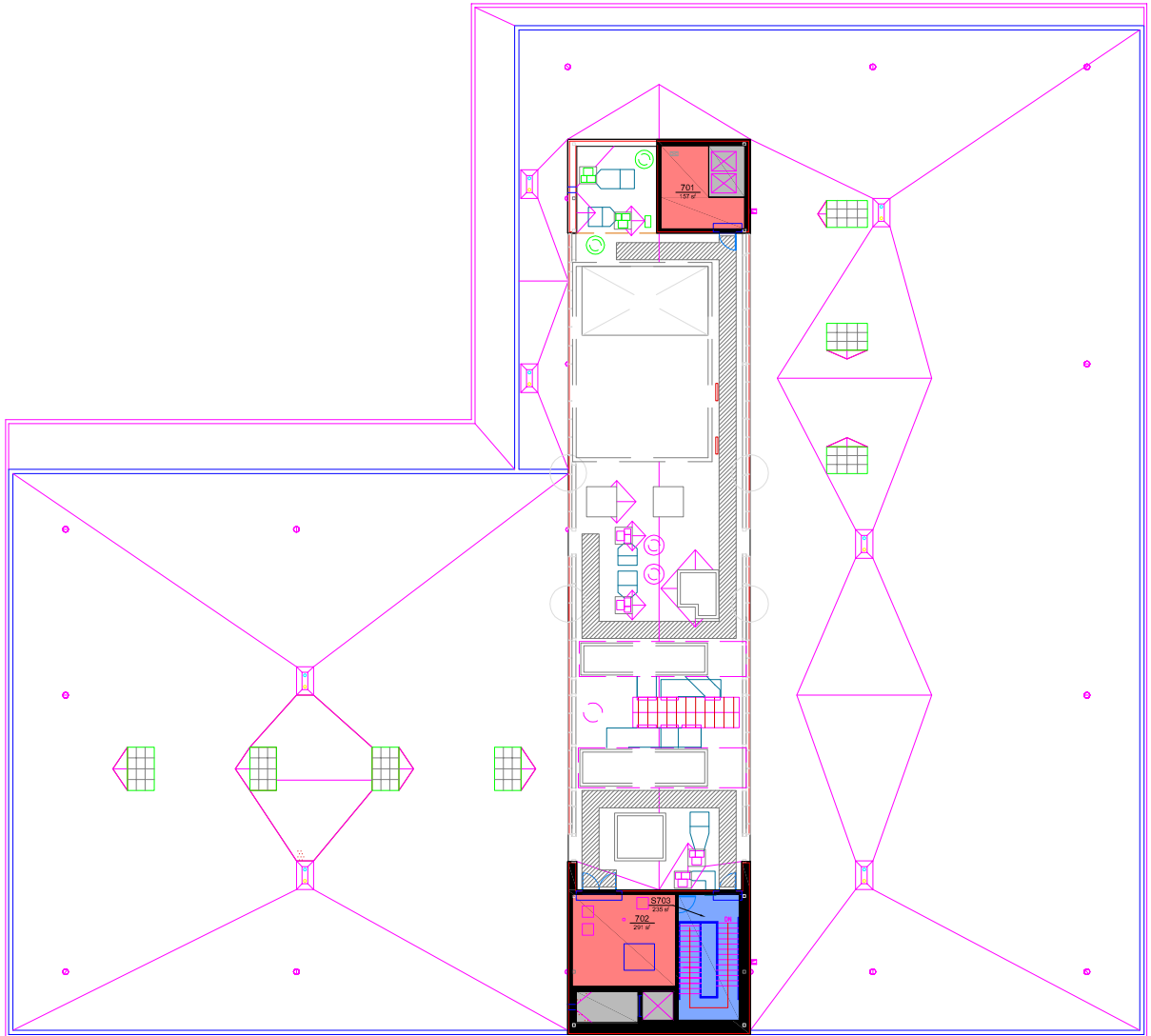
Print Date: 10/2010

Last Modified Date: 10/2010



STANDARD LAYER REPORT		
	AREA	QTY
 Circulation	235	1
 Mechanical Space	448	2
 Vertical Penetrations	143	3
TOTAL:	826	6
Floor Gross:	1096	

STANDARD SPACE REPORT

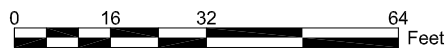

ACADEMIC STUDENT RECREATION CENTER Penthouse Floor Plan



1800 S. W. 6th Avenue, Portland, Oregon 97201

Print Date: 10/2010

Last Modified Date: 10/2010

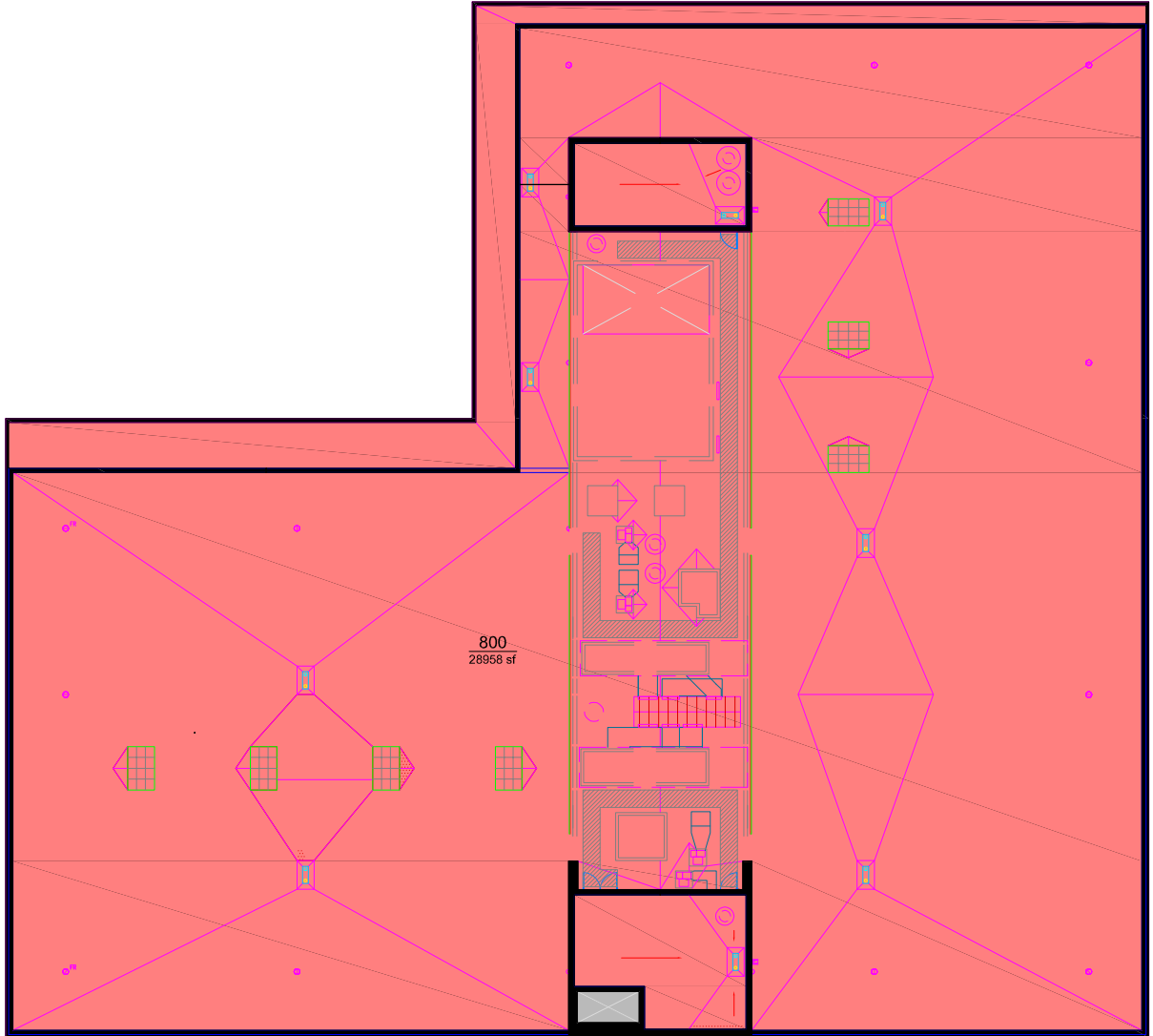



STANDARD LAYER REPORT			
		AREA	QTY
	Mechanical Space	28958	1
	Vertical Penetrations	59	1
TOTAL:		29017	2
Floor Gross:		30228	

STANDARD SPACE REPORT

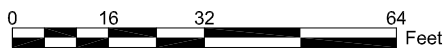

ACADEMIC STUDENT RECREATION CENTER Roof Plan

1800 S. W. 6th Avenue, Portland, Oregon 97201

Print Date: 10/2010

Last Modified Date: 10/2010



Portland State
UNIVERSITY

Capital Projects and Construction
<http://www.pdx.edu/construction>