

Cramer Hall (CH)

MAIN ENTRANCE ON BASEMENT

If you need assistance, or an accommodation to access an office or classroom please contact:
For Students - Disability Resource Center at For Employees -Human Resources at
(503) 725-4150 (503) 725-4926

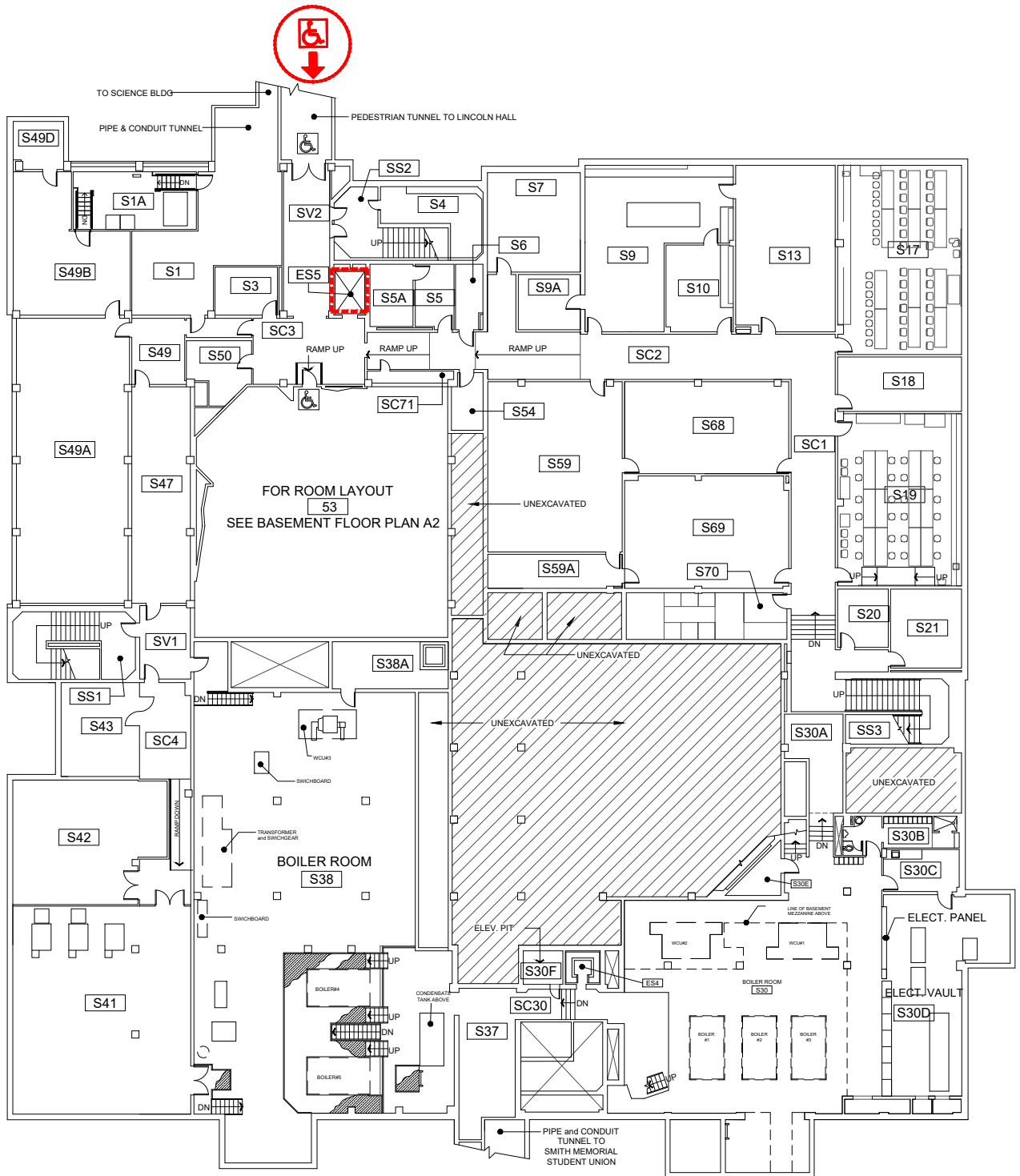

Scale
 1/32" = 1'-0"



ELEVATOR ACCESS



WHEELCHAIR ACCESS



BUILDING ACCESS - NOT
 WHEELCHAIR ACCESSIBLE



Sub-Basement
 Cramer Hall
 1721 SW Broadway, Portland, OR 97201

DRAWN BY:
 ASL
 DATE:
 04/2020

201_A1

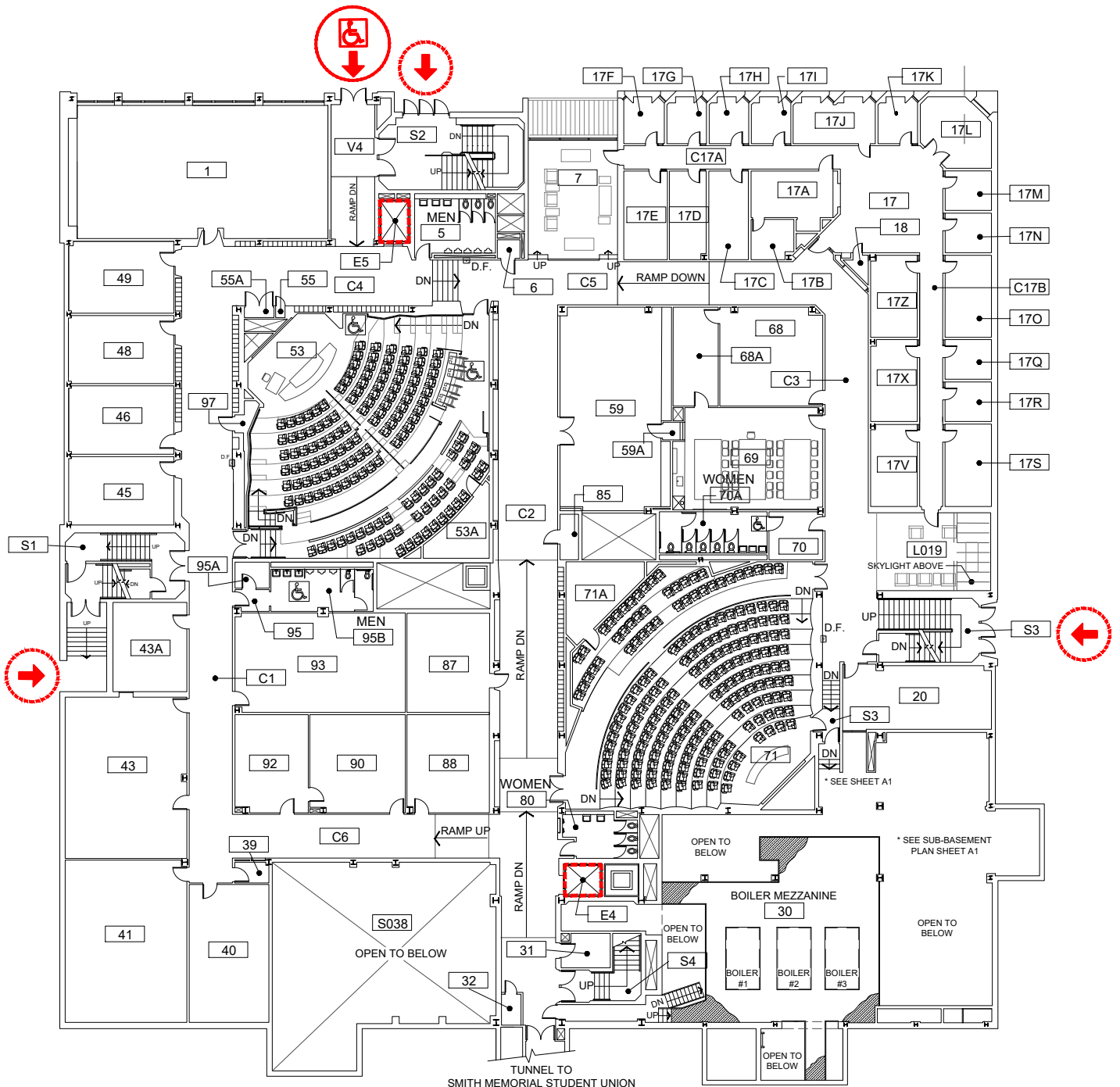

Scale
1/32" = 1'-0"

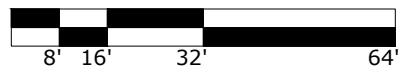

ELEVATOR ACCESS



WHEELCHAIR ACCESS



BUILDING ACCESS - NOT
WHEELCHAIR ACCESSIBLE

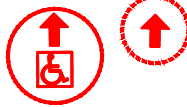
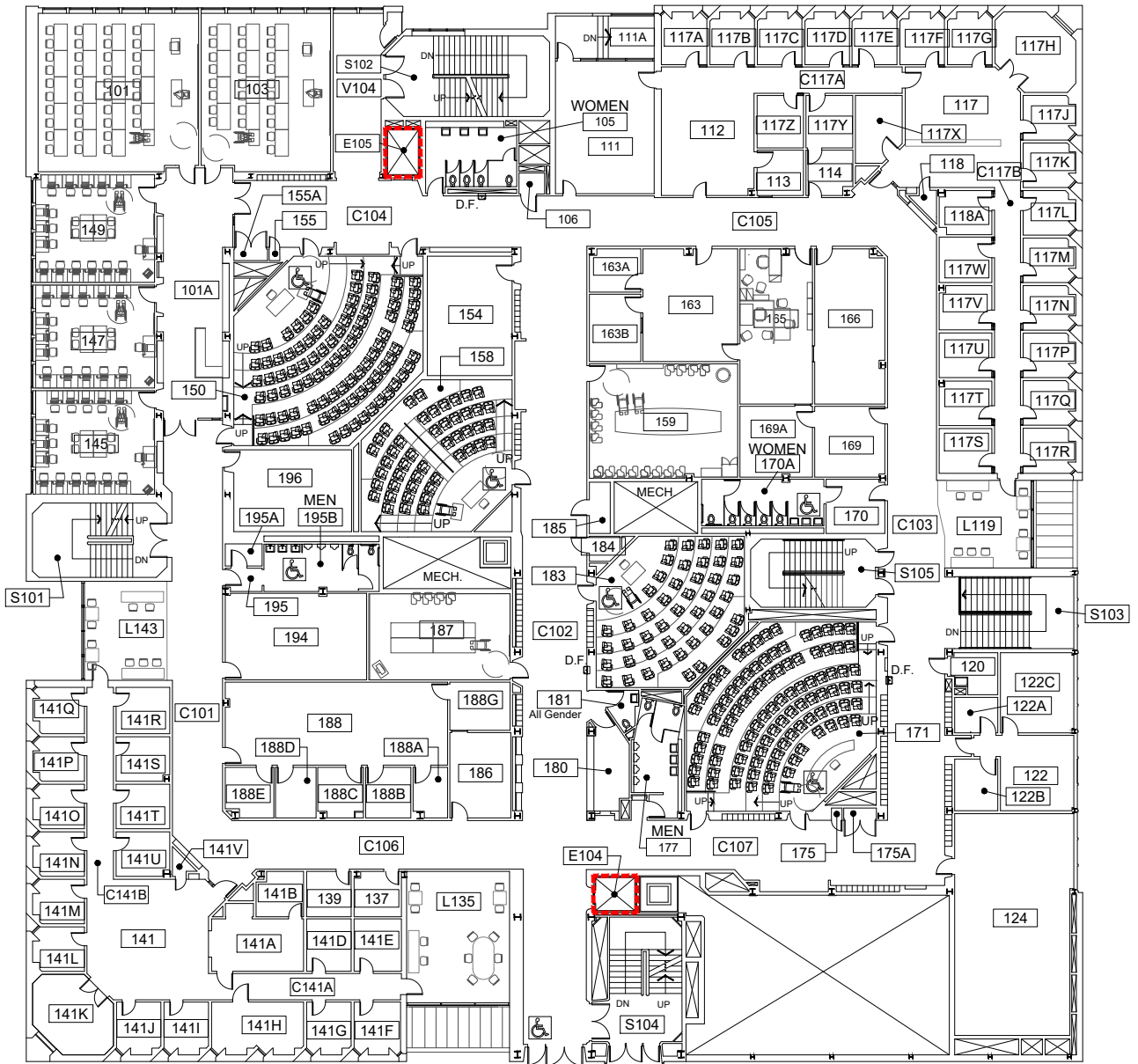

Scale
1/32" = 1'-0"

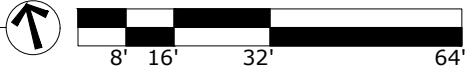

First Floor
Cramer Hall
1721 SW Broadway, Portland, OR 97201

DRAWN BY:
ASL
DATE:
04/2020

201_A3

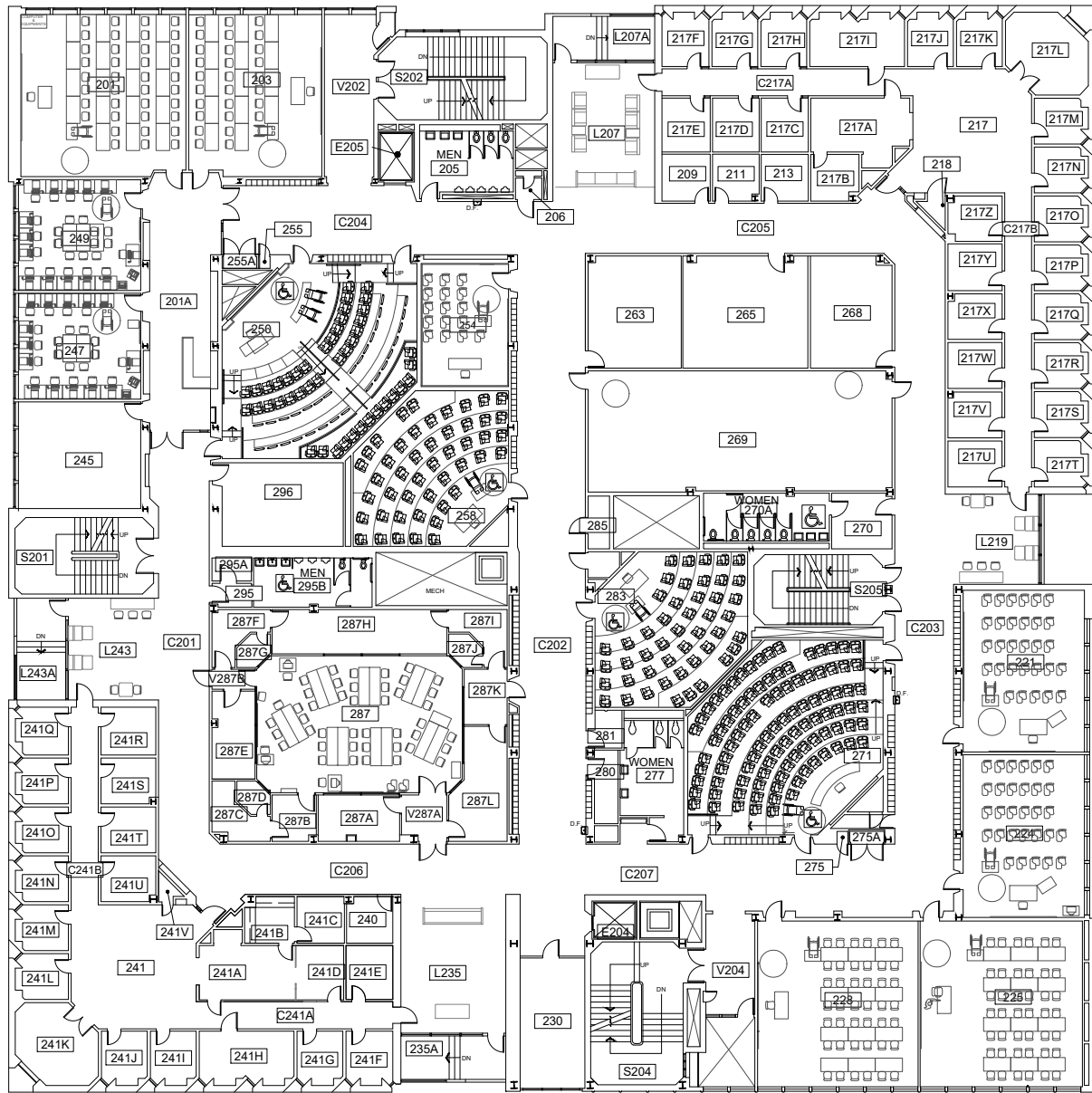

Scale
1/32" = 1'-0"



Second Floor
Cramer Hall
1721 SW Broadway, Portland, OR 97201

DRAWN BY:
ASL
DATE:
04/2020

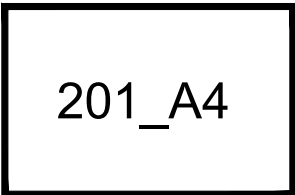



ENCLOSED PEDESTRIAN SKY BRIDGE TO LINCOLN HALL

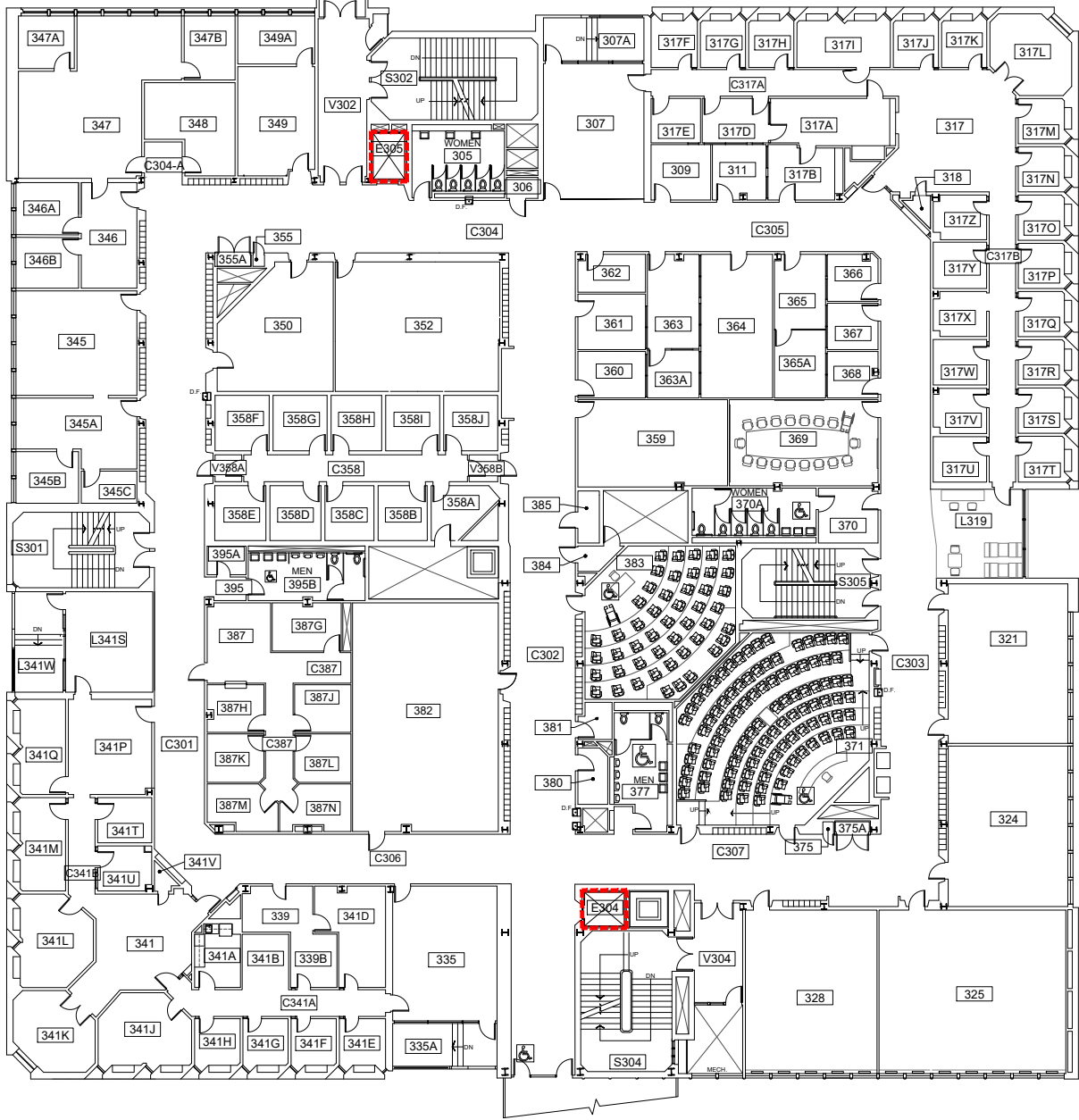

OPEN PEDESTRIAN SKY BRIDGE TO SMITH MEMORIAL STUDENT UNION



Scale

1/32" = 1'-0"



ELEVATOR ACCESS



WHEELCHAIR ACCESS



BUILDING ACCESS - NOT WHEELCHAIR ACCESSIBLE



Third Floor
Cramer Hall
1721 SW Broadway, Portland, OR 97201

DRAWN BY:
ASL
DATE:
04/2020

201_A5

ROOF OF SKY BRIDGE

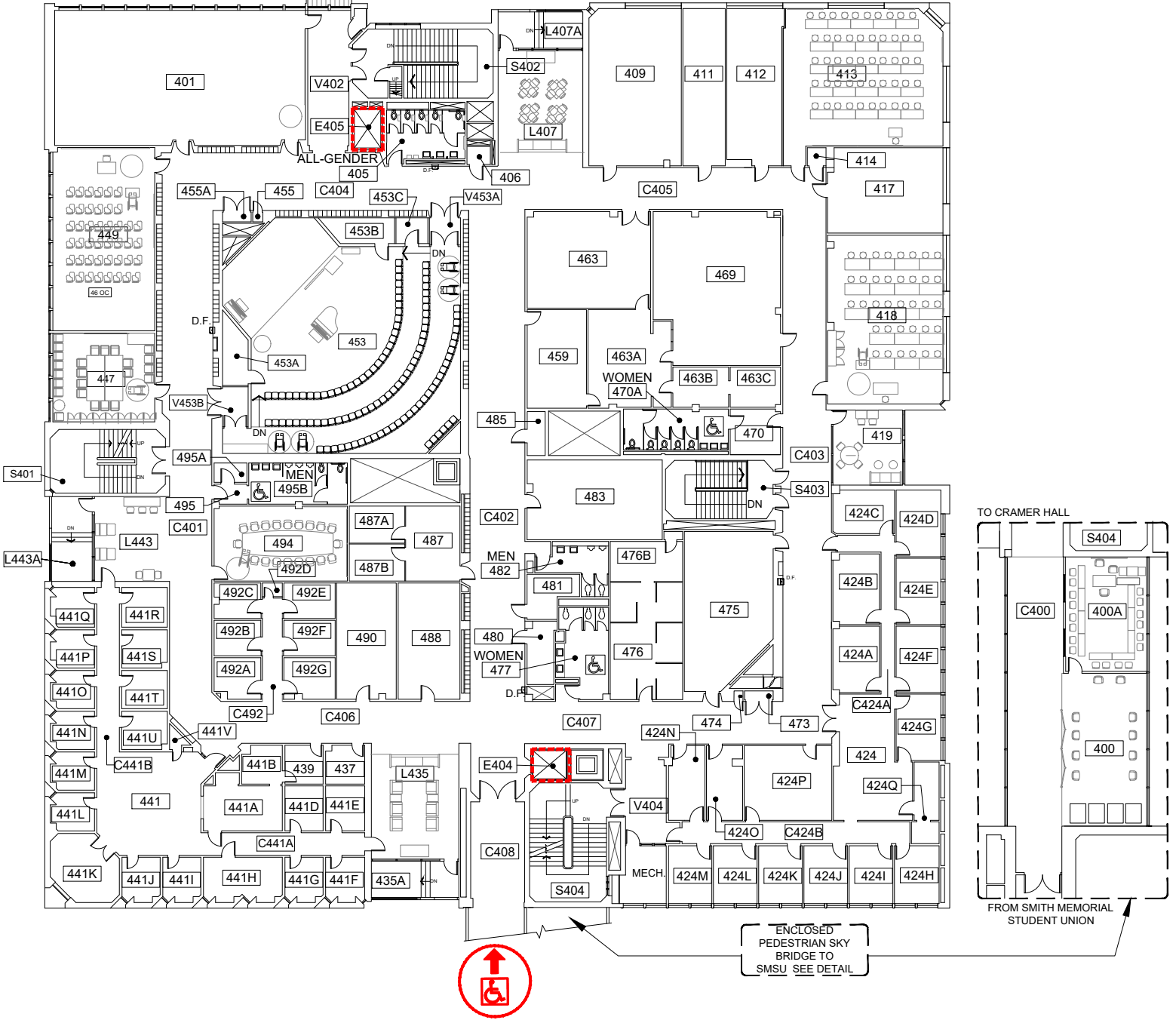

Scale
1/32" = 1'-0"



 ELEVATOR ACCESS

 WHEELCHAIR ACCESS

 BUILDING ACCESS - NOT WHEELCHAIR ACCESSIBLE



Fourth Floor
Cramer Hall
1721 SW Broadway, Portland, OR 97201

DRAWN BY:
ASL
DATE:
04/2020

201_A6

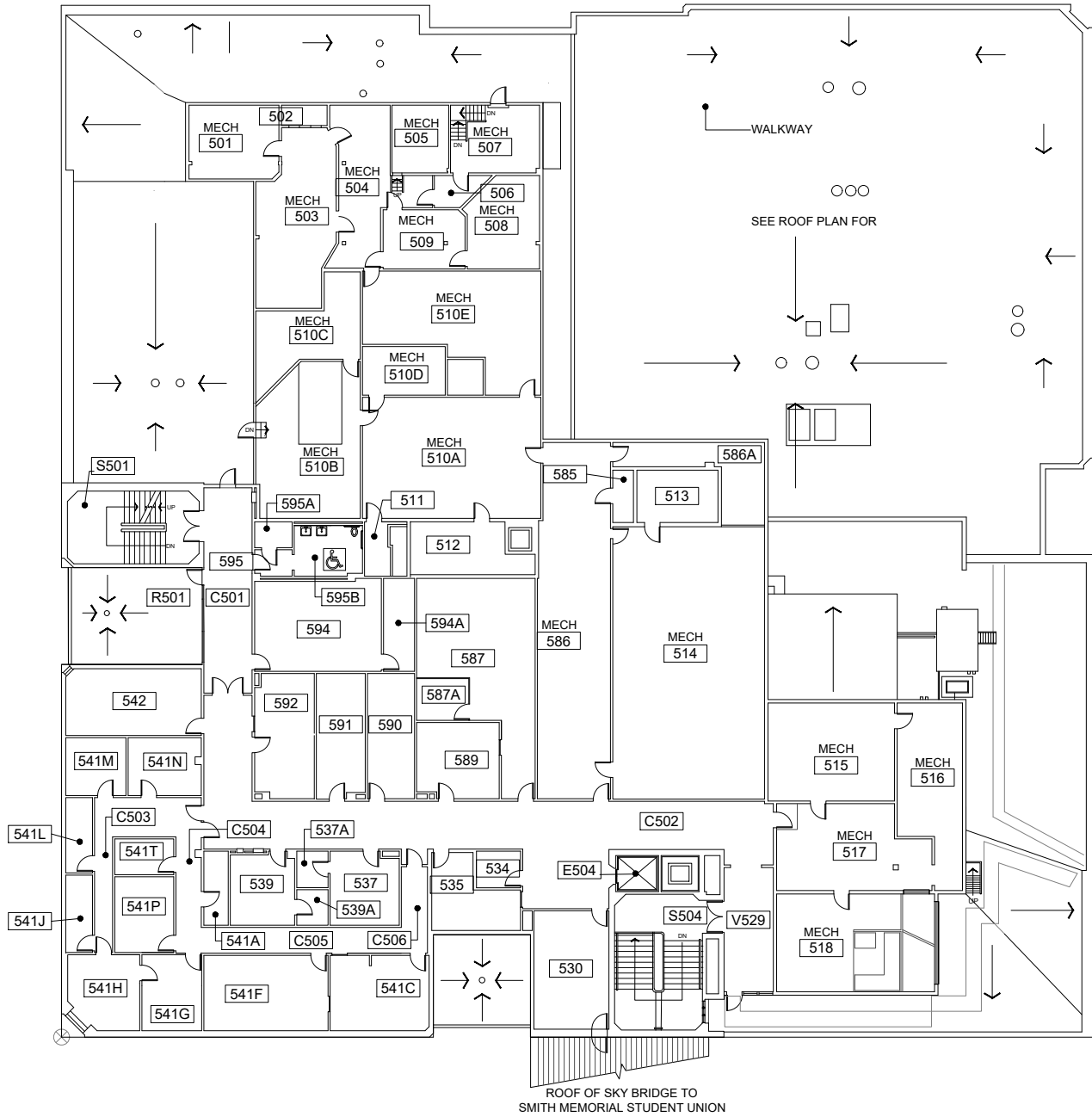

Scale
1/32" = 1'-0"

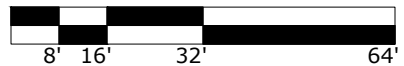

Fifth Floor
Cramer Hall
1721 SW Broadway, Portland, OR 97201

DRAWN BY:
ASL
DATE:
04/2020

201_A7

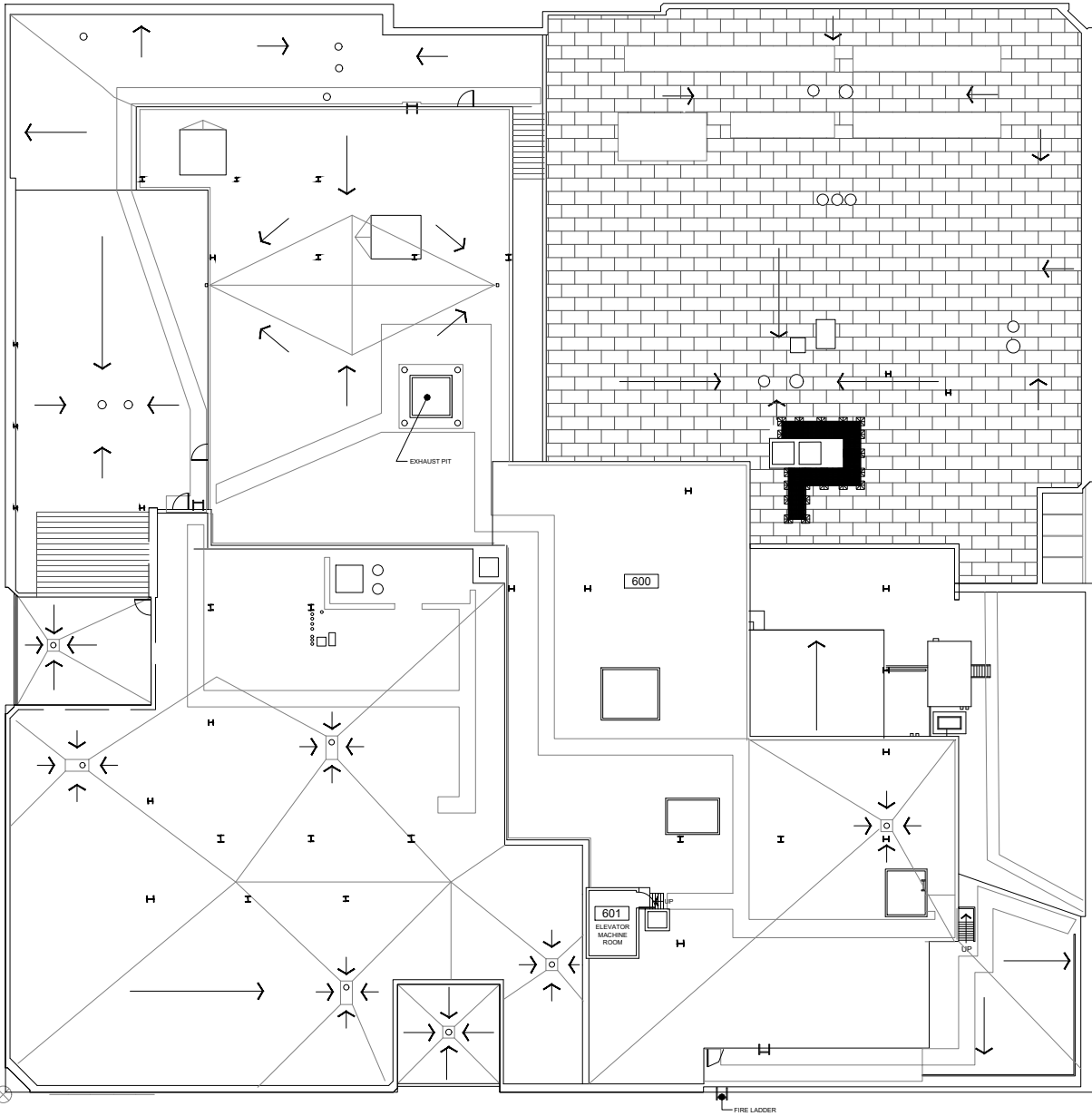

Scale

1/32" = 1'-0"

