

Cramer Hall (CH)

MAIN ENTRANCE ON BASEMENT

If you need assistance, or an accommodation to access an office or classroom please contact:
For Students - Disability Resource Center at For Employees -Human Resources at
(503) 725-4150 (503) 725-4926

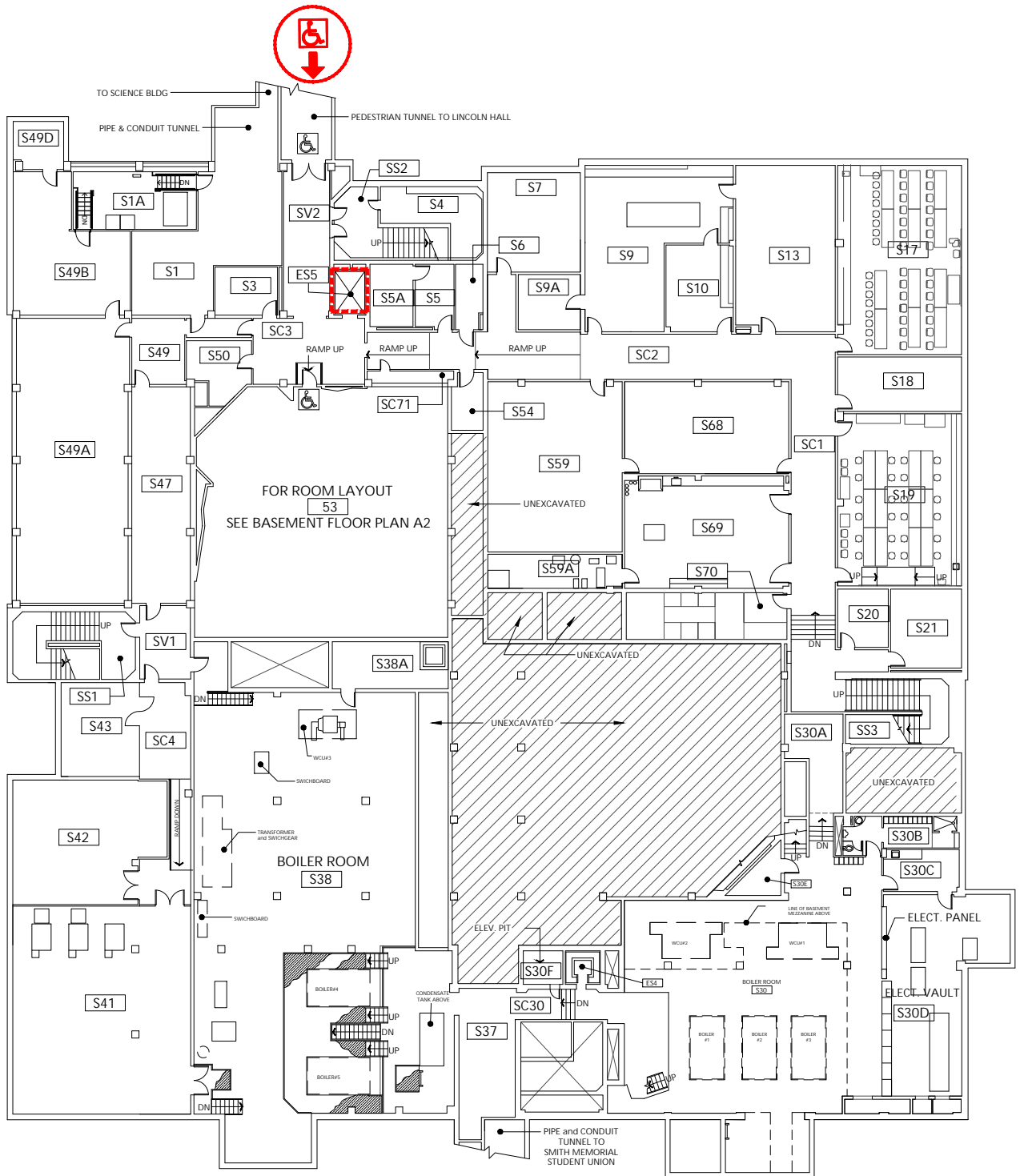

Sub-Basement
 1/32" = 1'-0"

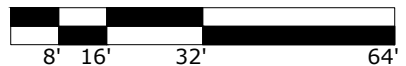

ELEVATOR ACCESS



WHEELCHAIR ACCESS



BUILDING ACCESS - NOT
 WHEELCHAIR ACCESSIBLE



CH
 Cramer Hall
 1721 SW Broadway

DRAWN BY:
 NR
 DATE:
 04/2024

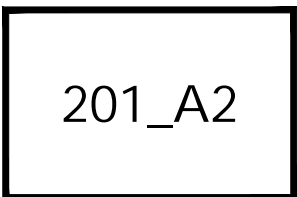

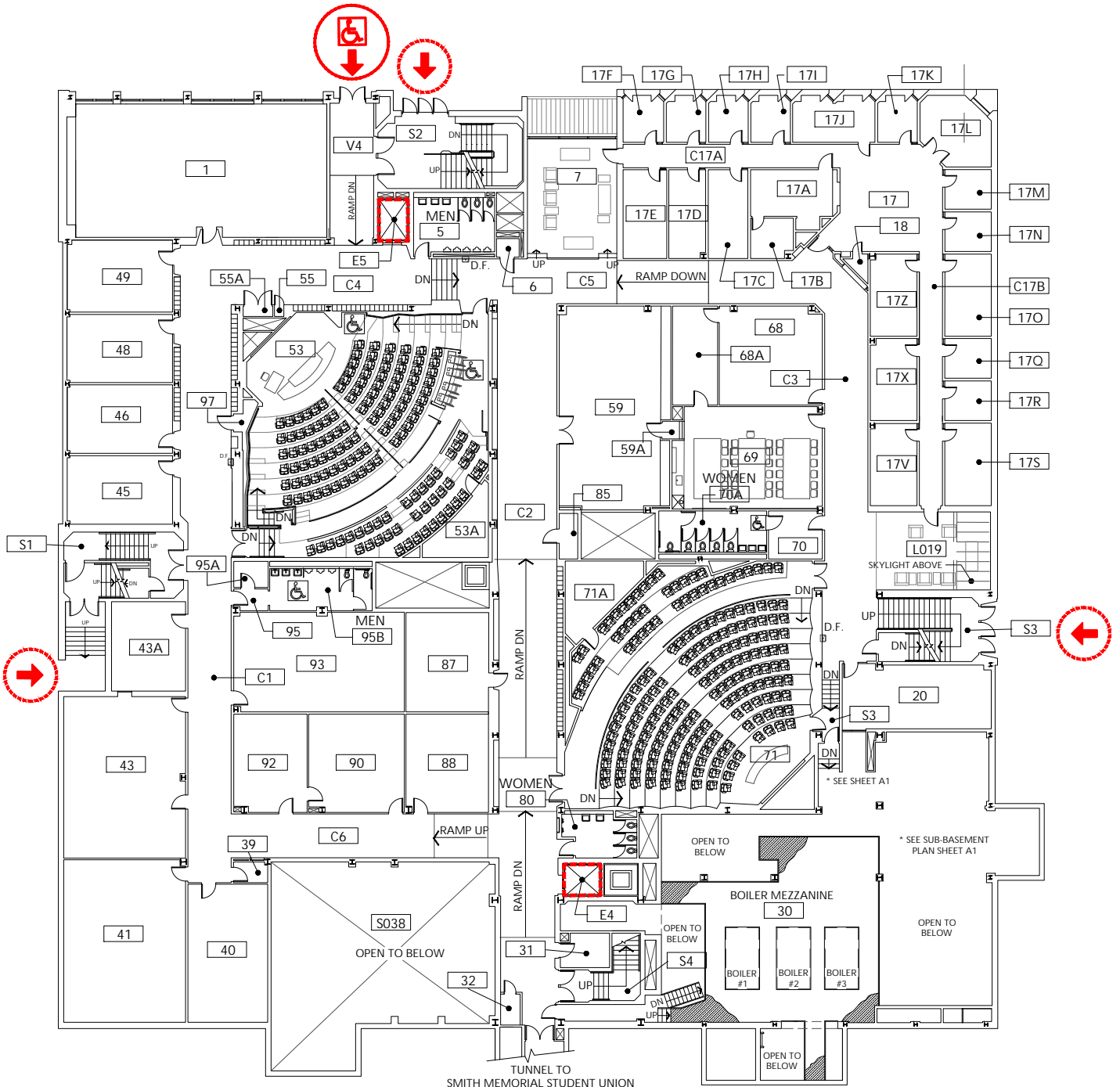

Basement
 1/32" = 1'-0"



ELEVATOR ACCESS



WHEELCHAIR ACCESS



BUILDING ACCESS - NOT
 WHEELCHAIR ACCESSIBLE



CH
 Cramer Hall
 1721 SW Broadway

DRAWN BY:
 NR
 DATE:
 04/2024

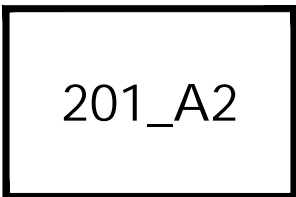

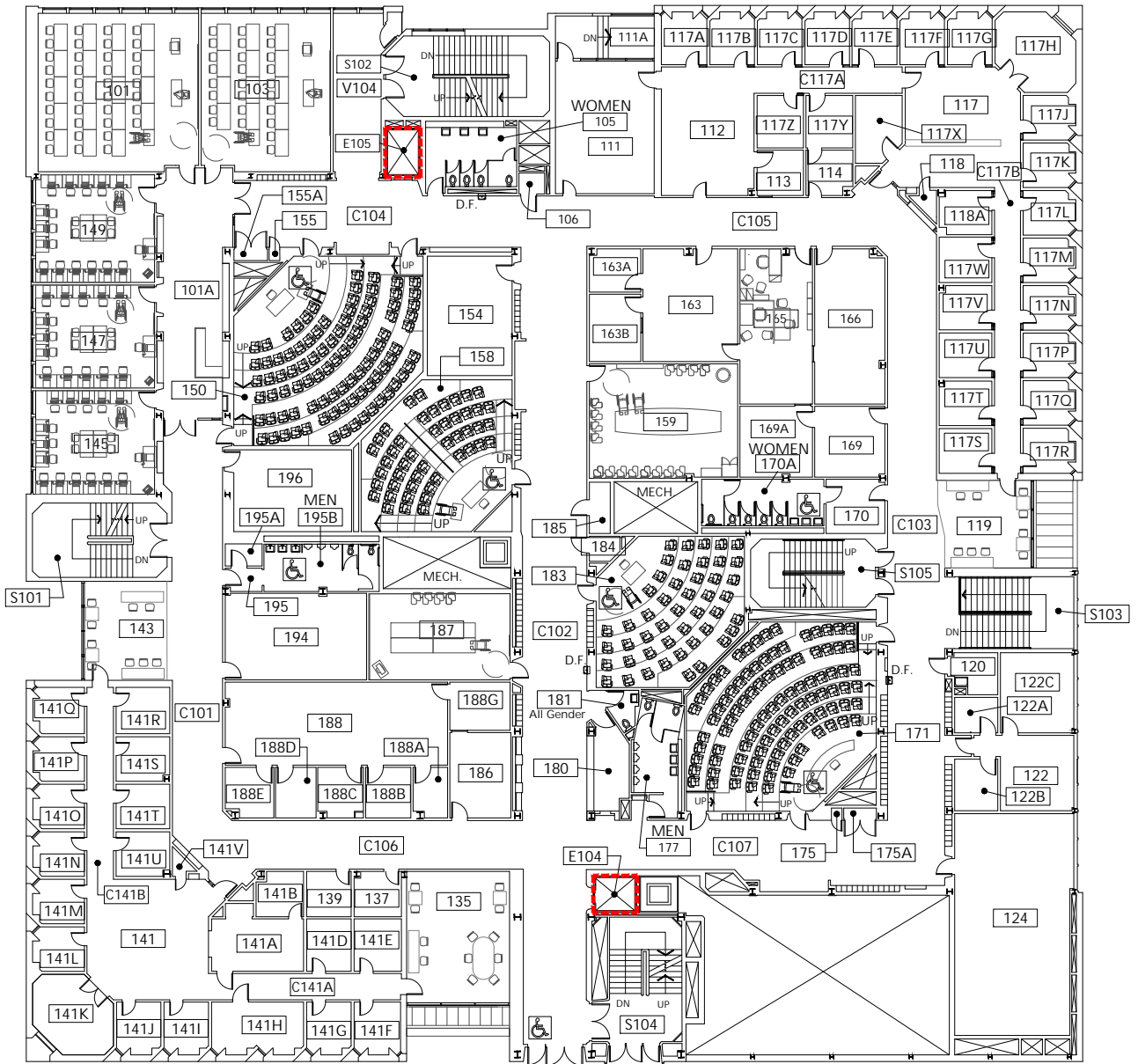

First Floor
 1/32" = 1'-0"



- 
 ELEVATOR ACCESS
- 
 WHEELCHAIR ACCESS
- 
 BUILDING ACCESS - NOT WHEELCHAIR ACCESSIBLE



CH
 Cramer Hall
 1721 SW Broadway

DRAWN BY:
 NR
 DATE:
 04/2024

201_A3

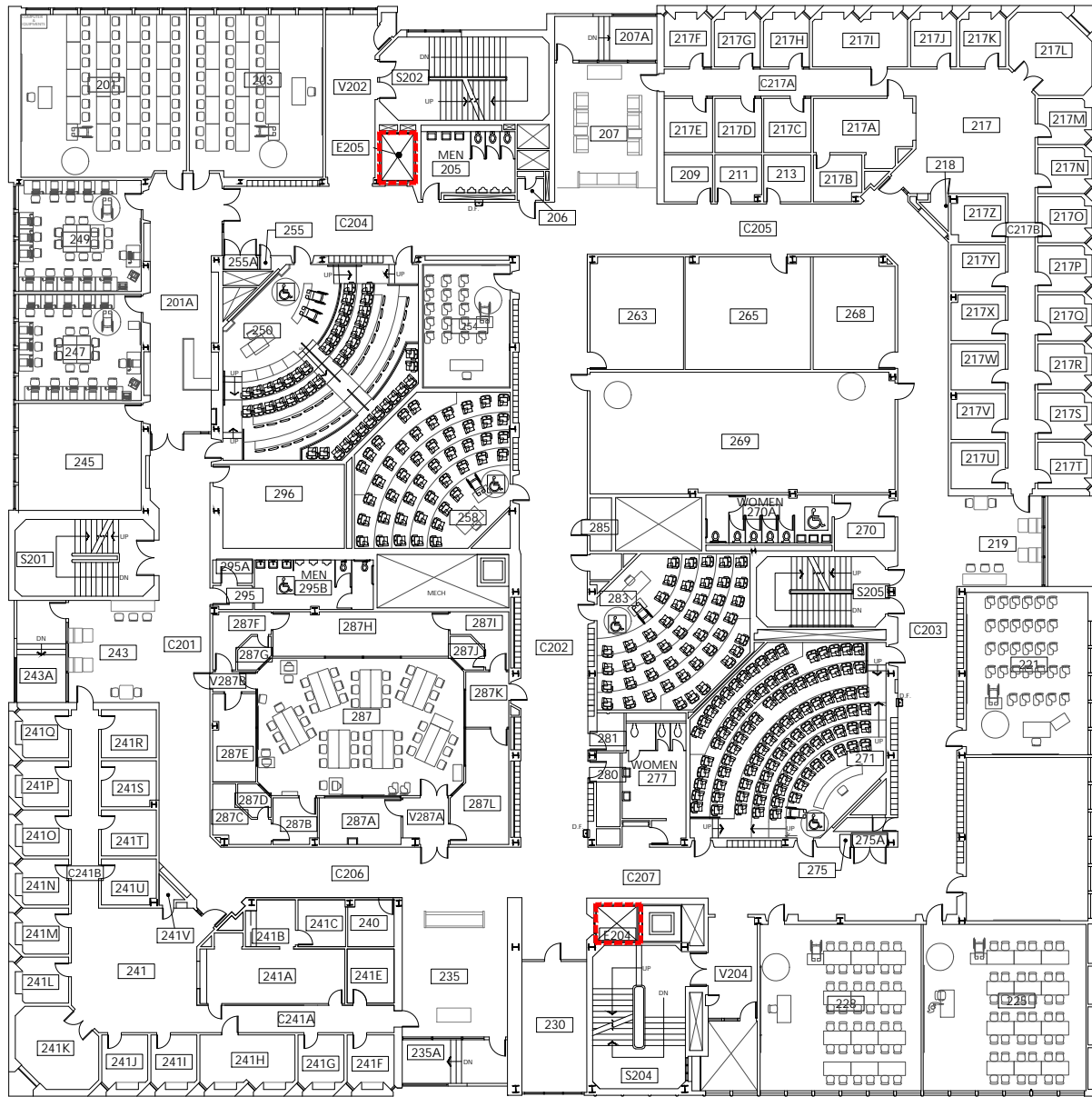

Second Floor
 1/32" = 1'-0"

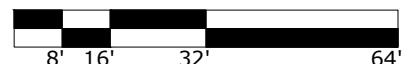

ELEVATOR ACCESS



WHEELCHAIR ACCESS



BUILDING ACCESS - NOT
 WHEELCHAIR ACCESSIBLE



CH
 Cramer Hall
 1721 SW Broadway

DRAWN BY:
 NR
 DATE:
 04/2024

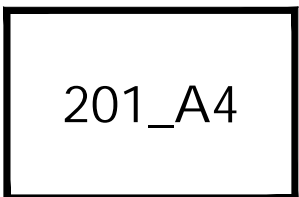



ENCLOSED PEDESTRIAN SKY BRIDGE TO LINCOLN HALL

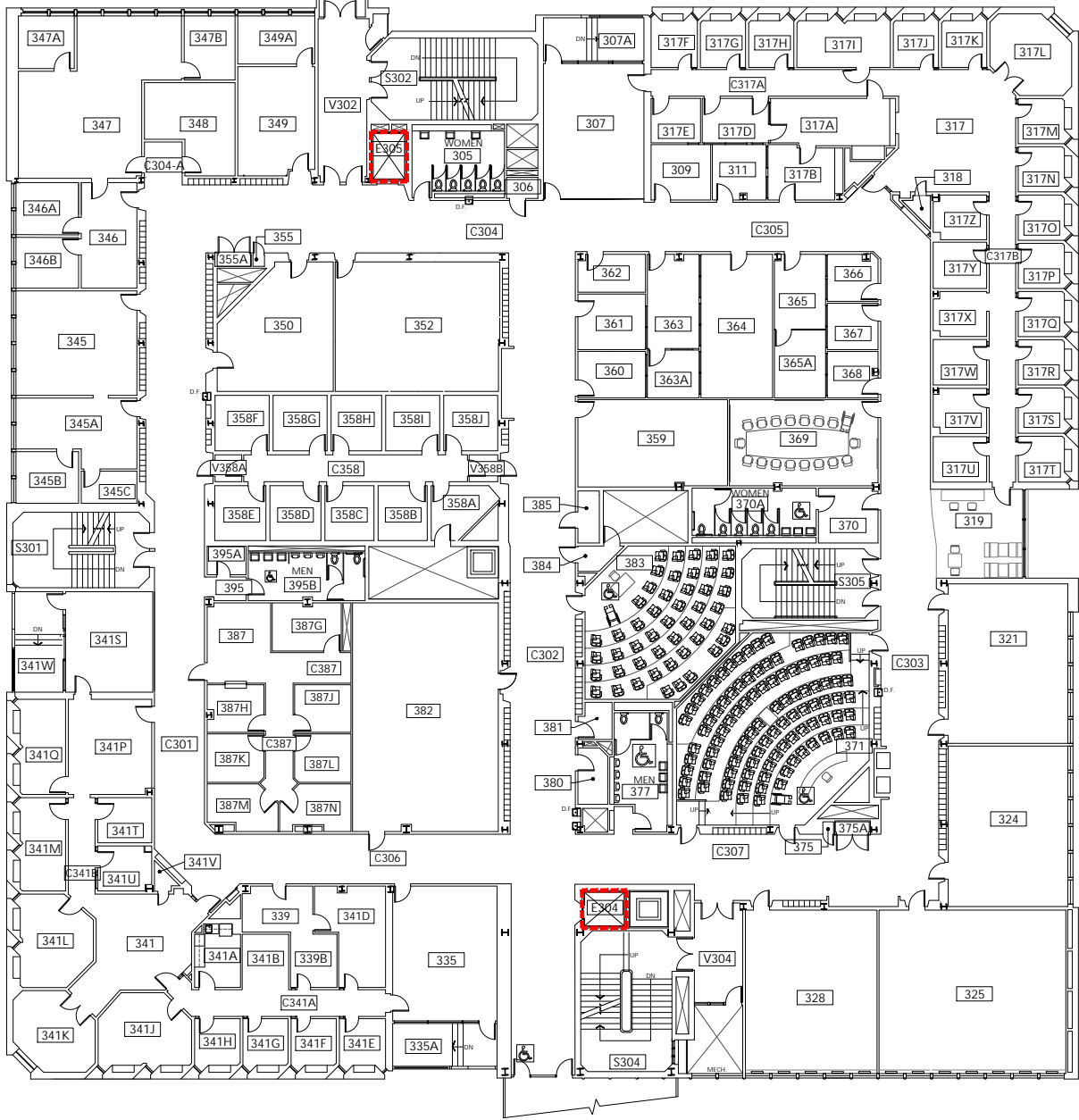

OPEN PEDESTRIAN SKY BRIDGE TO SMITH MEMORIAL STUDENT UNION



Third Floor
1/32" = 1'-0"



ELEVATOR ACCESS



WHEELCHAIR ACCESS



BUILDING ACCESS - NOT WHEELCHAIR ACCESSIBLE



CH
Cramer Hall
1721 SW Broadway

DRAWN BY:
NR
DATE:
04/2024



ROOF OF SKY BRIDGE

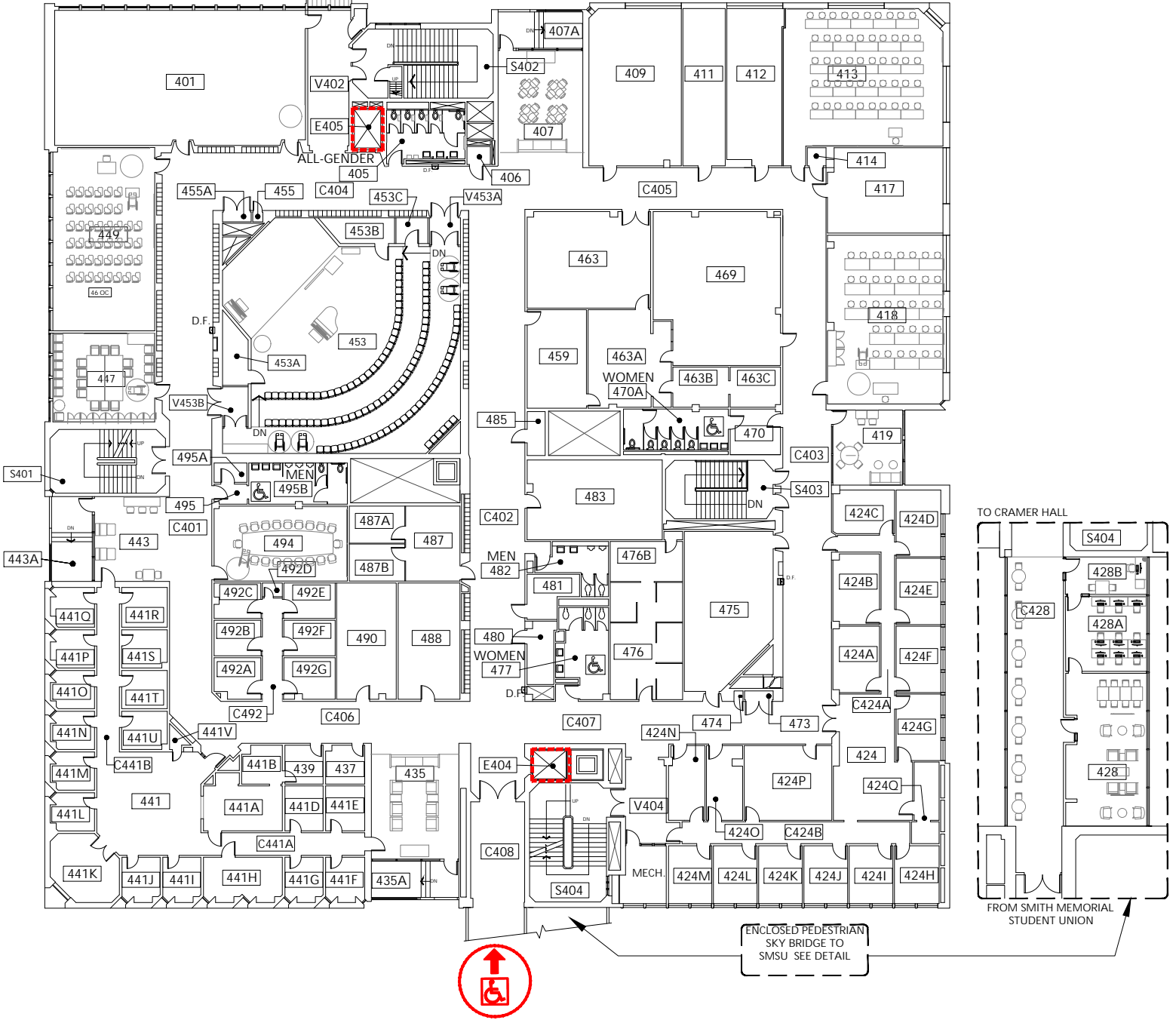

Fourth Floor
1/32" = 1'-0"



ELEVATOR ACCESS



WHEELCHAIR ACCESS



BUILDING ACCESS - NOT WHEELCHAIR ACCESSIBLE



CH
Cramer Hall
1721 SW Broadway

DRAWN BY:
NR
DATE:
04/2024

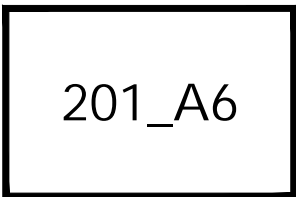

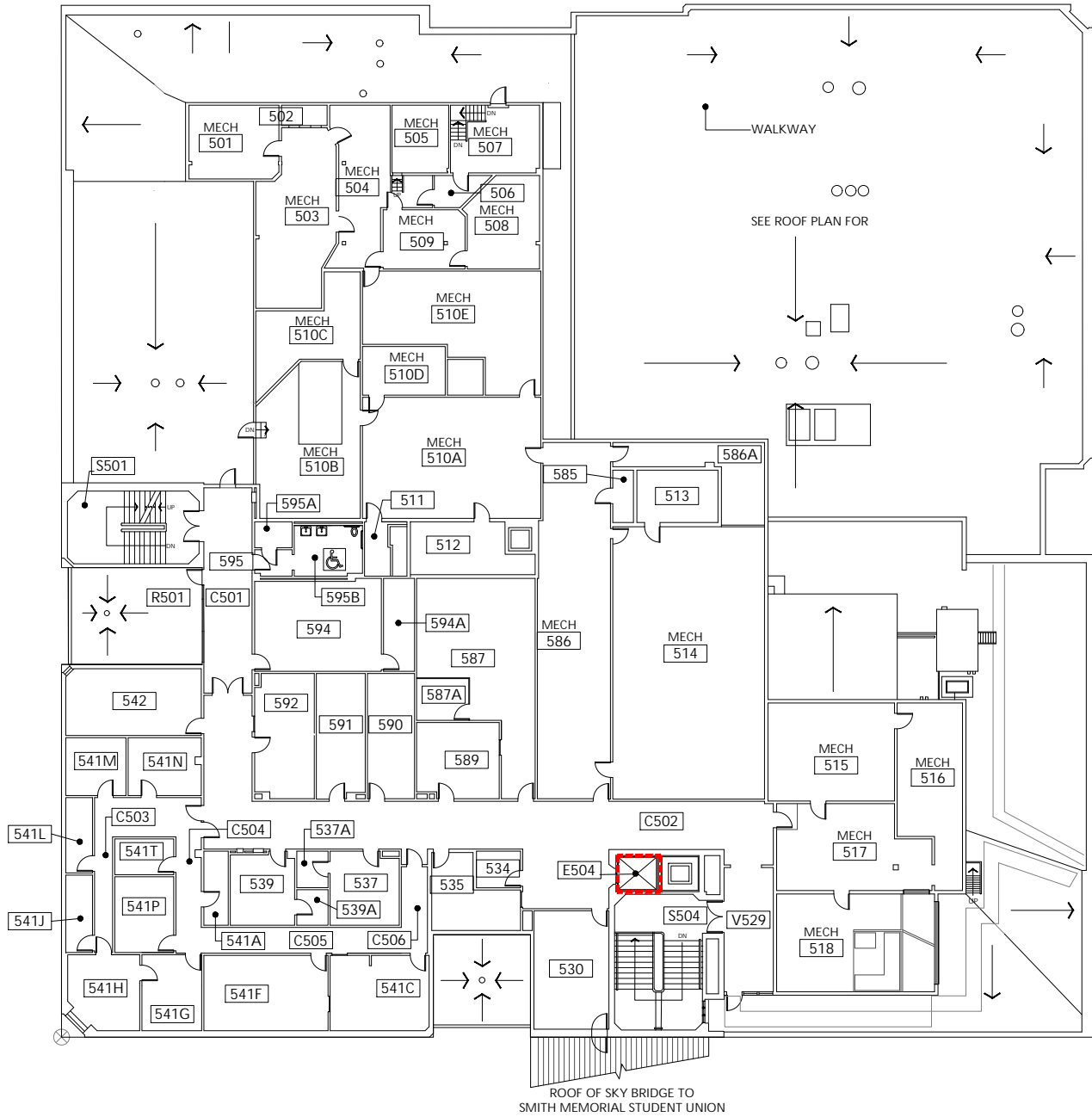

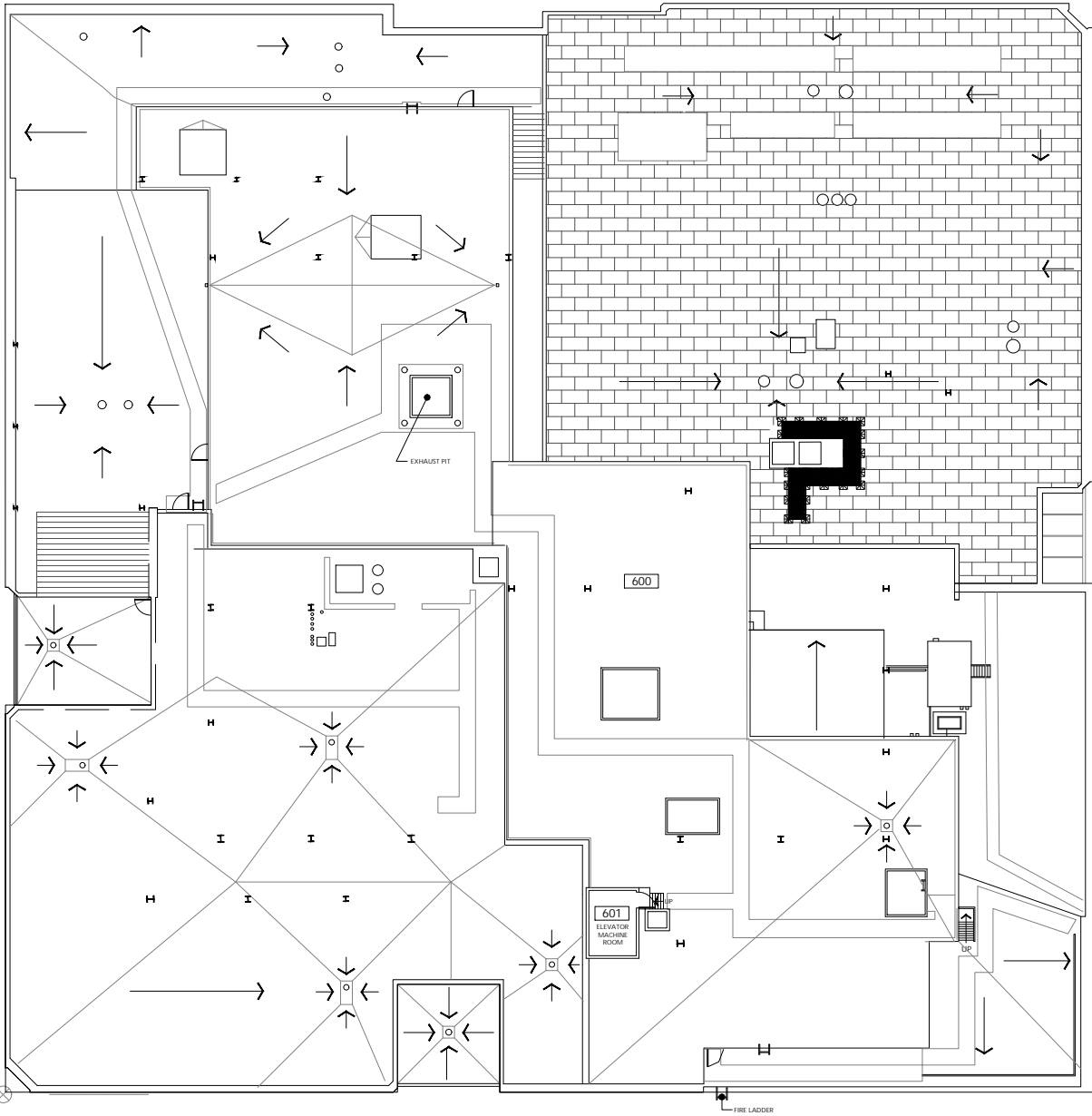

Roof Plan
 $1/32" = 1'-0"$

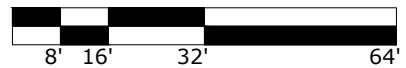

CH
 Cramer Hall
 1721 SW Broadway

DRAWN BY:
 NR
 DATE:
 04/2024

