





| STANDARD LAYER REPORT | | | |
|---|-----------------------|--------|-----|
| | | AREA | QTY |
|  | Building Services | 896 | 5 |
|  | Circulation | 1,914 | 7 |
|  | Mechanical Space | 42 | 1 |
|  | Net Assignable Space | 7,834 | 20 |
|  | Vertical Penetrations | 139 | 2 |
| | TOTAL: | 10,825 | 35 |
| | Floor Gross: | 12,187 | |

STANDARD SPACE REPORT

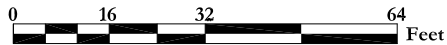

NATIVE AMERICAN STUDENT COMMUNITY CENTER

First Floor Plan

710 SW Jackson Street Portland, Oregon 97201



Print Date:

Last Modified Date: 06/2016

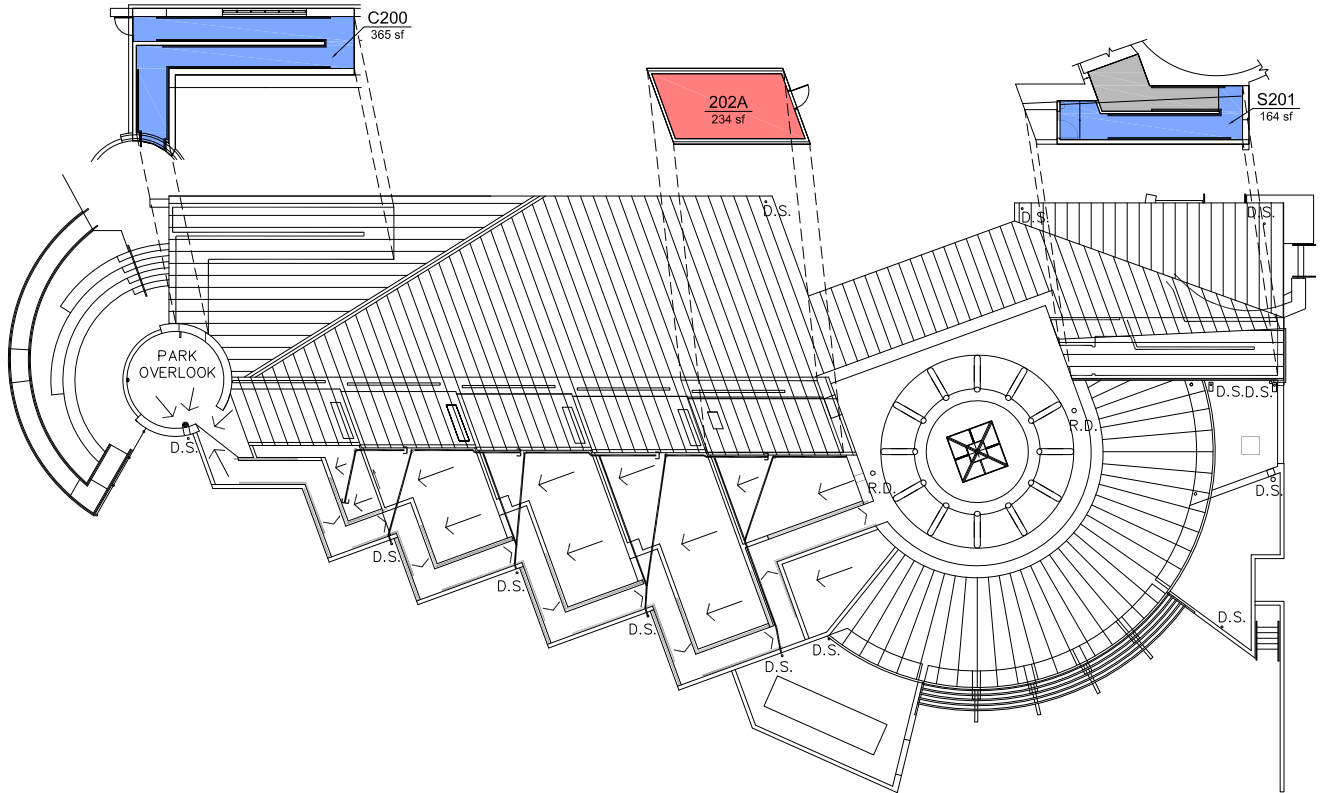

Campus Planning Office
<http://www.pdx.edu/campus-planning>



| STANDARD LAYER REPORT | | | |
|---|-----------------------|------|-----|
| | | AREA | QTY |
|  | Circulation | 529 | 2 |
|  | Mechanical Space | 234 | 1 |
|  | Vertical Penetrations | 122 | 1 |
| | TOTAL: | 885 | 4 |
| | Floor Gross: | 619 | |

STANDARD SPACE REPORT

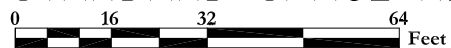

NATIVE AMERICAN STUDENT COMMUNITY CENTER

Second Floor Plan

710 SW Jackson Street Portland, Oregon 97201

Print Date:

Last Modified Date: 06/2016



Campus Planning Office
<http://www.pdx.edu/campus-planning>

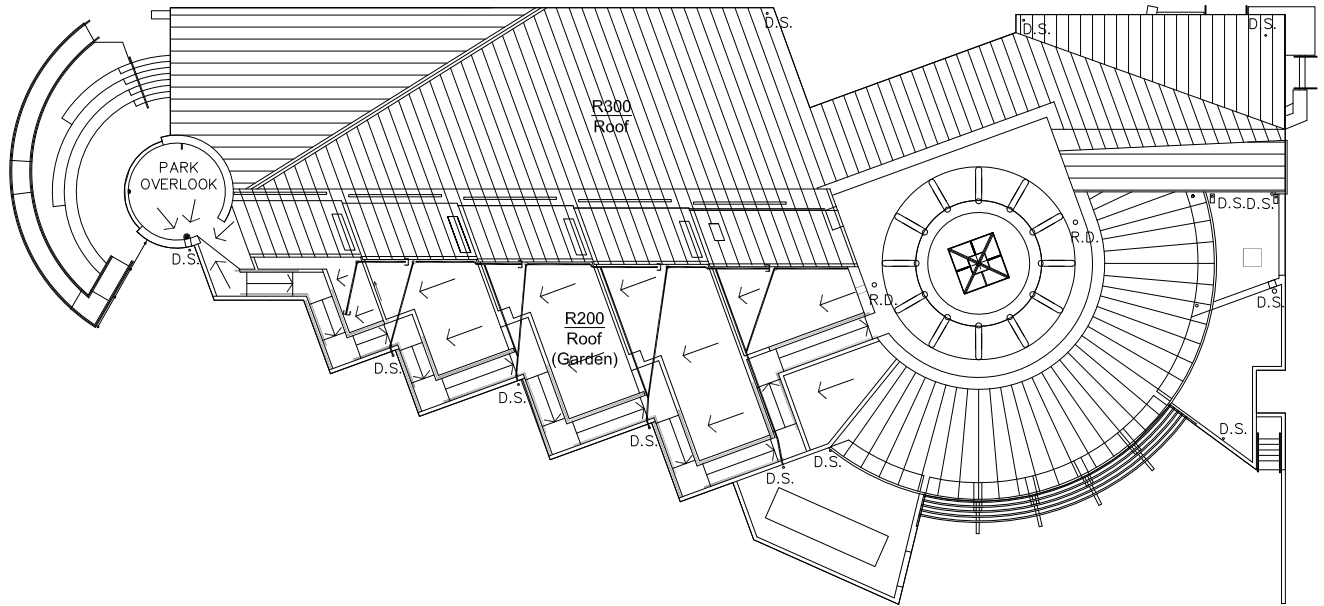

STANDARD SPACE REPORT

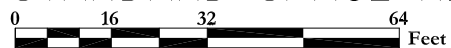

NATIVE AMERICAN STUDENT COMMUNITY CENTER

Roof Plan

710 SW Jackson Street Portland, Oregon 97201

Print Date:

Last Modified Date: 06/2016



Portland State
UNIVERSITY

Campus Planning Office
<http://www.pdx.edu/campus-planning>