

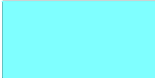



STANDARD LAYER REPORT

		<u>AREA</u>	<u>QTY</u>
	Building Services	501	3
	Circulation	589	3
	Mechanical Space	746	2
	Net Assignable Space	2,115	6
	Vertical Penetrations	136	4
	TOTAL:	4,087	18
	Floor Gross:	4,615	

STANDARD SPACE REPORT

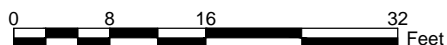

KING ALBERT BUILDING
Basement Floor Plan

1809 SW Eleventh Avenue, Portland, Oregon 97201-3259



Print Date:

Last Modified Date: 06/2018

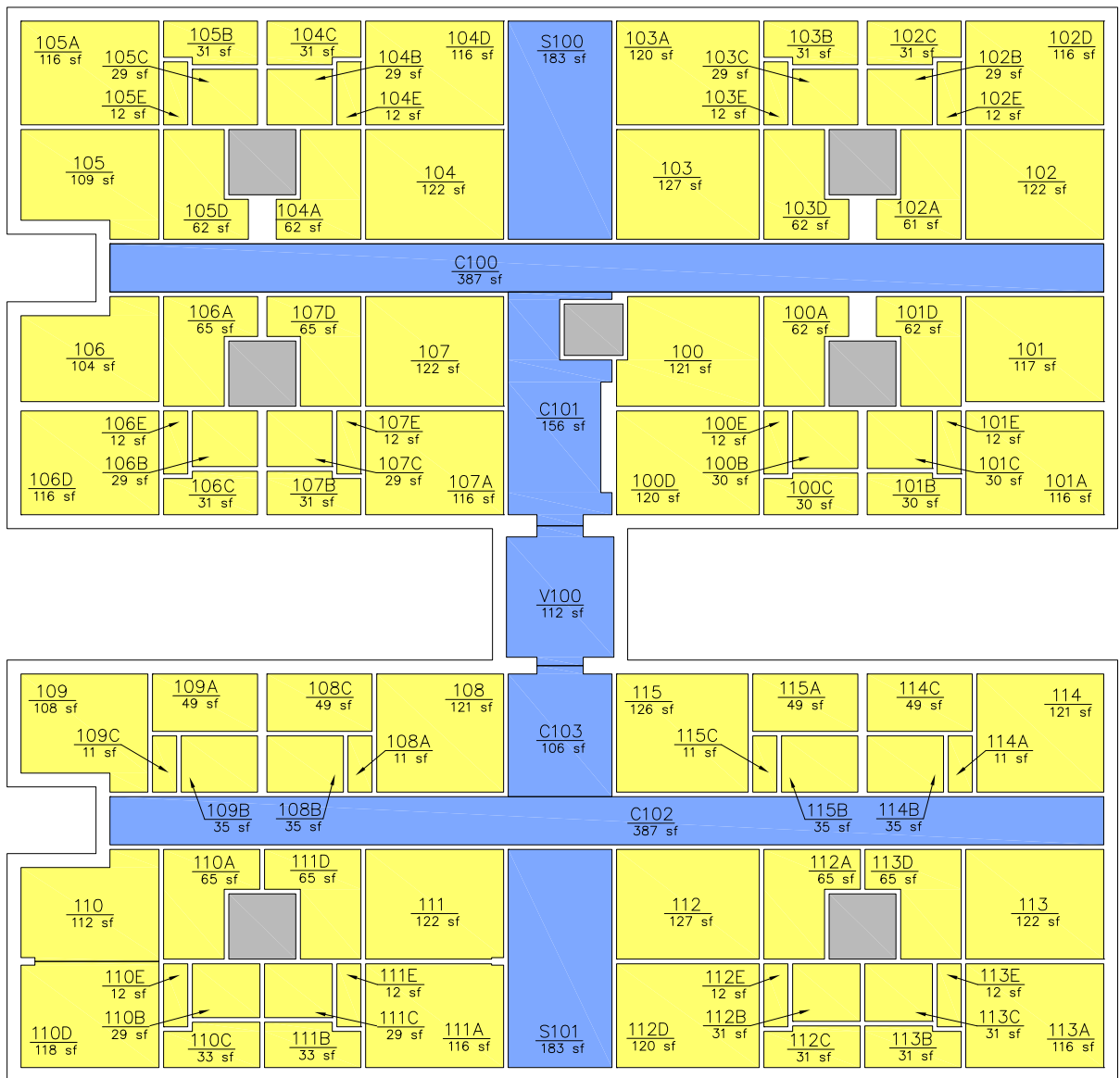

Campus Planning Office
<http://www.pdx.edu/planning-sustainability>



STANDARD LAYER REPORT		
	AREA	QTY
 Circulation	1,514	7
 Net Assignable Space	5,322	88
 Vertical Penetrations	236	7
TOTAL:	7,072	102
Floor Gross:	8,524	

STANDARD SPACE REPORT

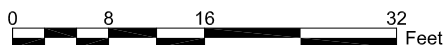

KING ALBERT BUILDING

First Floor Plan

1809 SW Eleventh Avenue, Portland, Oregon 97201-3259

Print Date: 10/2010



Last Modified Date: 10/2010

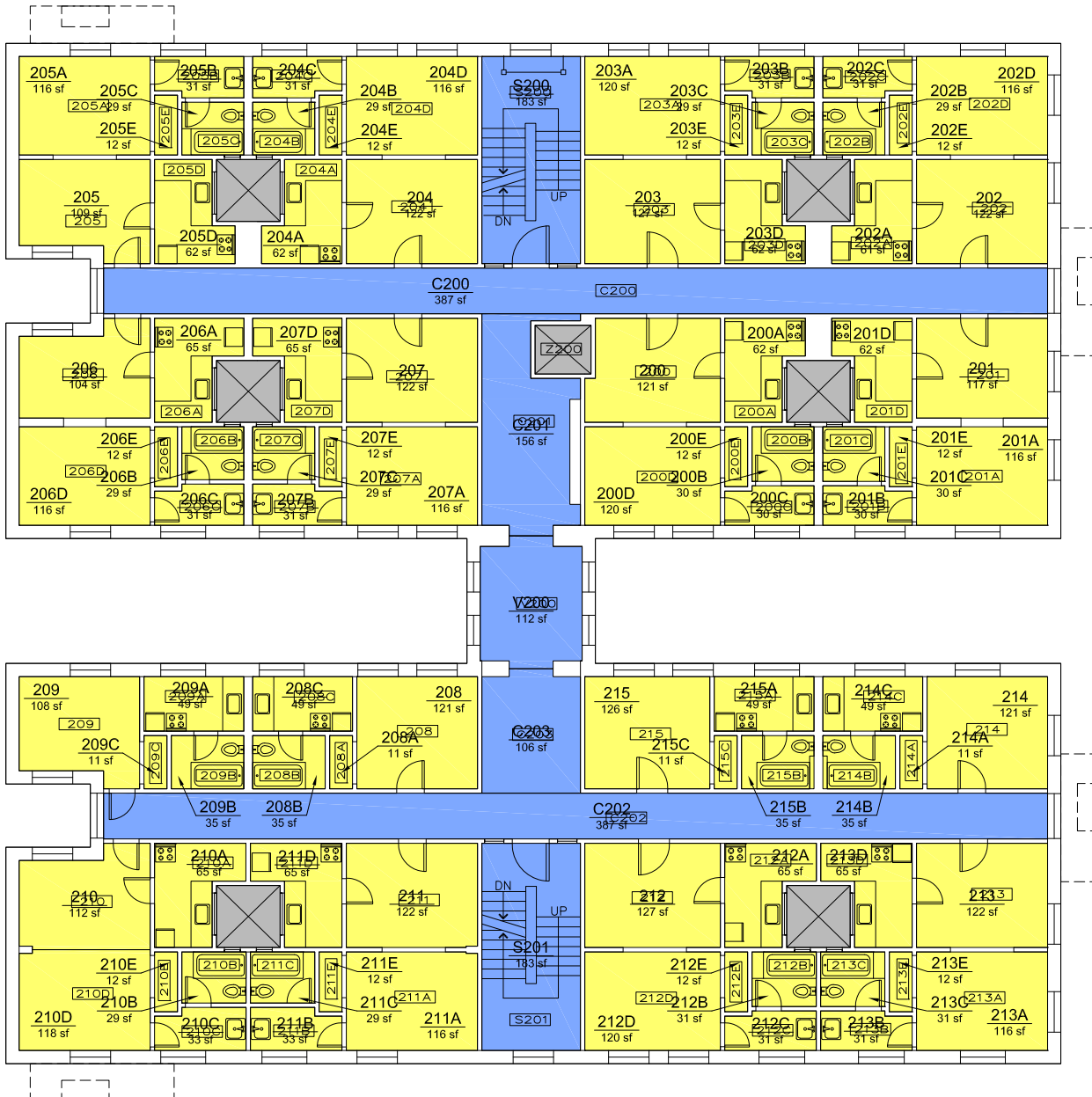

Campus Planning Office
<http://www.pdx.edu/planning-sustainability>

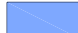

STANDARD LAYER REPORT



	AREA	QTY
 Circulation	1,514	7
 Net Assignable Space	5,322	88
 Vertical Penetrations	236	7
TOTAL:	7,072	102
Floor Gross:	8,524	

STANDARD SPACE REPORT

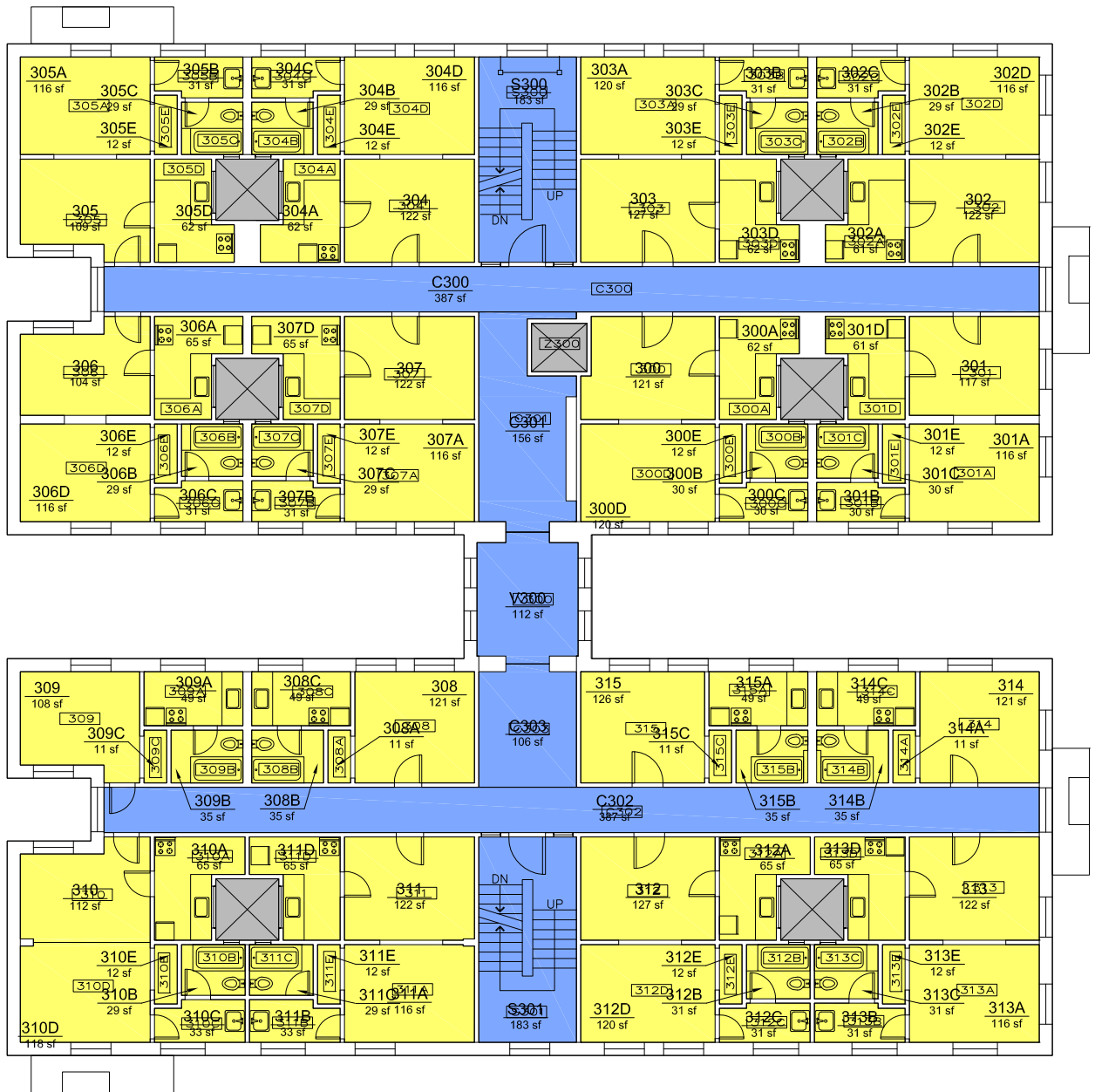

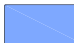

STANDARD LAYER REPORT

	AREA	QTY
 Circulation	1,514	7
 Net Assignable Space	5,321	88
 Vertical Penetrations	236	7
TOTAL:	7,071	102
Floor Gross:	8,525	

STANDARD SPACE REPORT

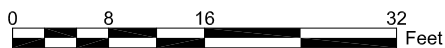

KING ALBERT BUILDING

Third Floor Plan

1809 SW Eleventh Avenue, Portland, Oregon 97201-3259



Print Date: 10/2010

Last Modified Date: 10/2010

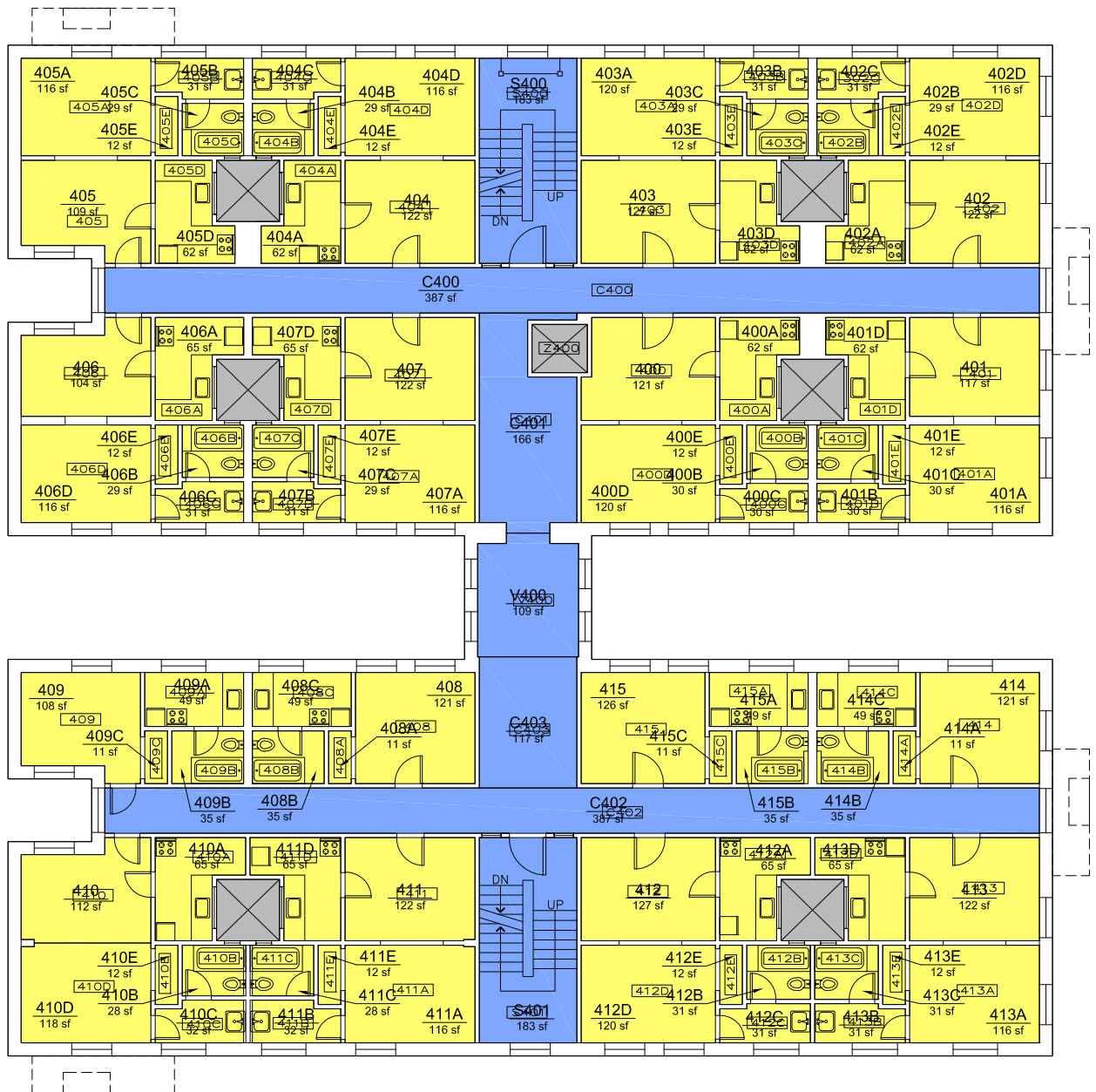

Campus Planning Office
<http://www.pdx.edu/planning-sustainability>



STANDARD LAYER REPORT		
		AREA QTY
	Circulation	1,532 7
	Net Assignable Space	5,319 88
	Vertical Penetrations	236 7
TOTAL:		7,087 102
Floor Gross:		8,524

STANDARD SPACE REPORT

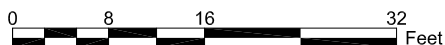

KING ALBERT BUILDING

Fourth Floor Plan

1809 SW Eleventh Avenue, Portland, Oregon 97201-3259

Print Date: 10/2010

Last Modified Date: 10/2010



Campus Planning Office
<http://www.pdx.edu/planning-sustainability>

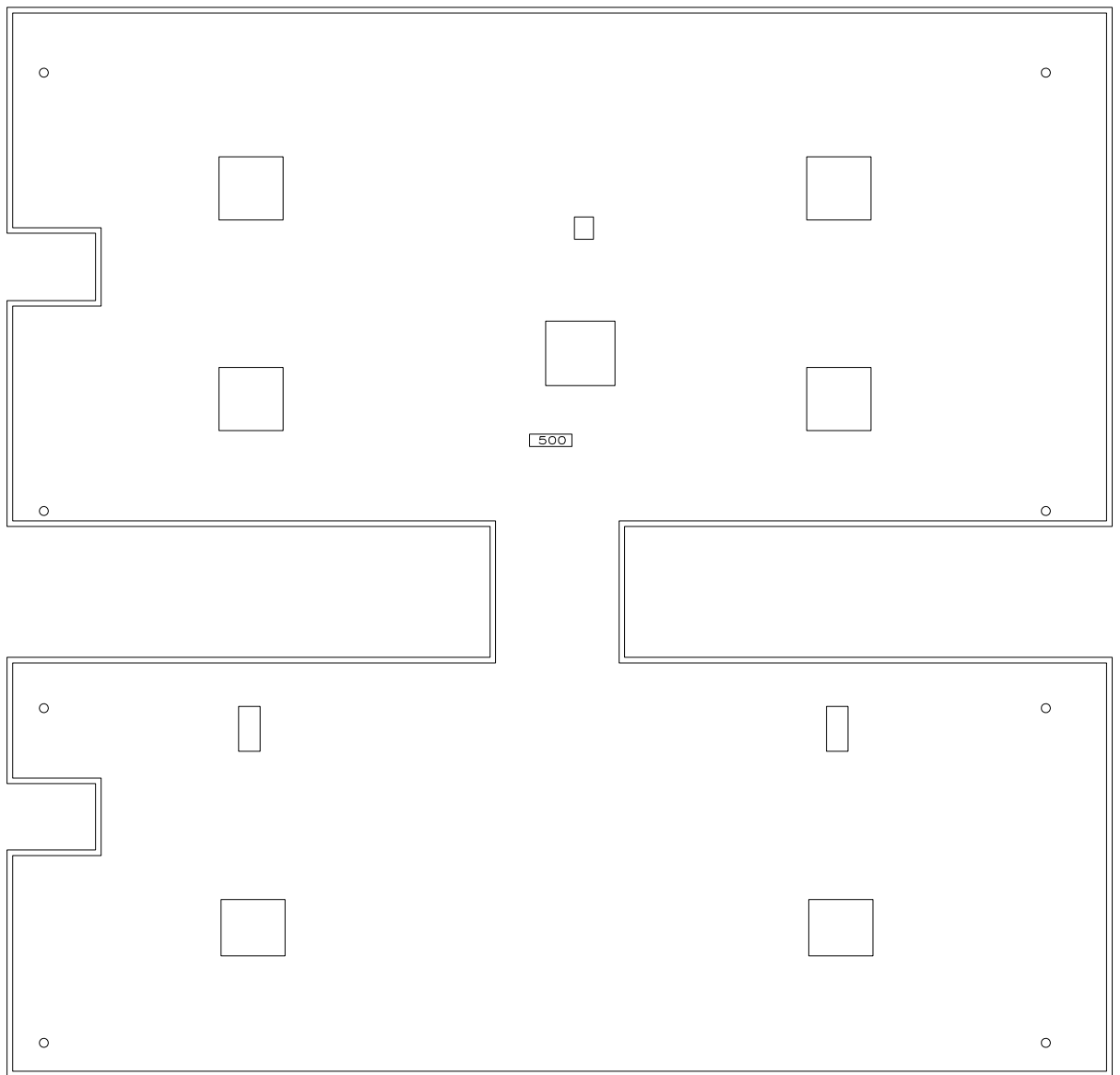

STANDARD SPACE REPORT

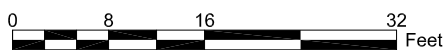

KING ALBERT BUILDING

Roof Plan

1809 SW Eleventh Avenue, Portland, Oregon 97201-3259

Print Date: 10/2010

Last Modified Date: 10/2010



Campus Planning Office
<http://www.pdx.edu/planning-sustainability>