



## STANDARD LAYER REPORT

		<u>AREA</u>	<u>QTY</u>
	Building Services	54	2
	Circulation	86	2
	Mechanical Space	484	1
	Net Assignable Space	707	7
	<b>TOTAL:</b>	<b>1,331</b>	<b>12</b>
	<b>Floor Gross:</b>	<b>1,608</b>	

## STANDARD SPACE REPORT



HARDER HOUSE  
 Basement Floor Plan  
 1604 SW Tenth Avenue, Portland, Oregon 97201  
 Print Date 10/2010  
 Last Modified Date 10/2010



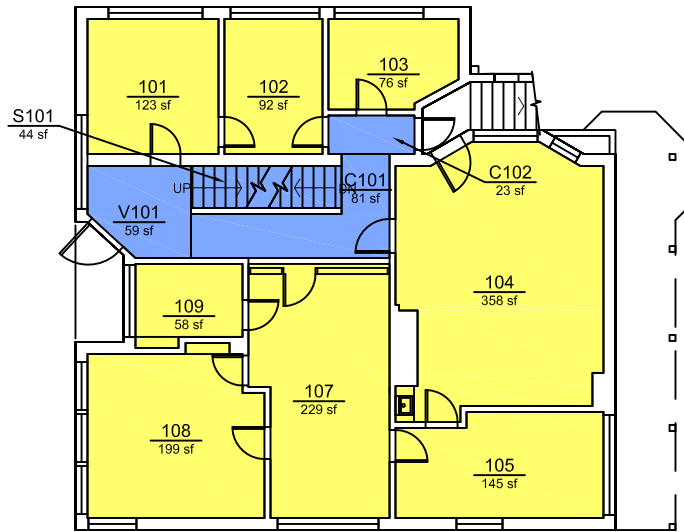

**Portland State**  
 UNIVERSITY

Campus Planning Office  
<http://www.pdx.edu/planning-sustainability>

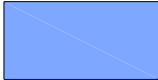

## STANDARD LAYER REPORT

		<u>AREA</u>	<u>QTY</u>
	Circulation	207	4
	Net Assignable Space	1,280	8
	<b>TOTAL:</b>	<b>1,487</b>	<b>12</b>
	<b>Floor Gross:</b>	<b>1,778</b>	

## STANDARD SPACE REPORT

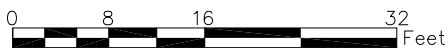

HARDER HOUSE  
 First Floor Plan  
 1604 SW Tenth Avenue, Portland, Oregon 97201  
 Print Date 10/2010  
 Last Modified Date 10/2010



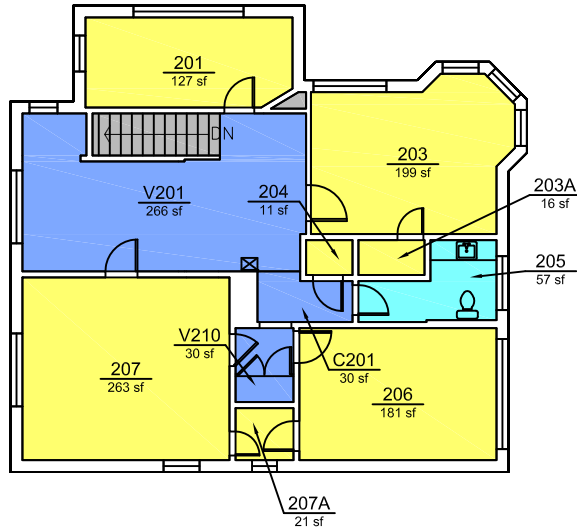

**Portland State**  
 UNIVERSITY

Campus Planning Office  
<http://www.pdx.edu/planning-sustainability>

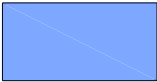

## STANDARD LAYER REPORT

		<u>AREA</u>	<u>QTY</u>
	Building Services	57	1
	Circulation	326	3
	Net Assignable Space	818	7
	Vertical Penetrations	40	2
	<b>TOTAL:</b>	<b>1,241</b>	<b>13</b>
	<b>Floor Gross:</b>	<b>1,485</b>	

## STANDARD SPACE REPORT

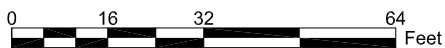

### HARDER HOUSE

Second Floor Plan

1604 SW Tenth Avenue, Portland, Oregon 97201

Print Date: 10/2010

Last Modified Date: 10/2010



Campus Planning Office  
<http://www.pdx.edu/planning-sustainability>

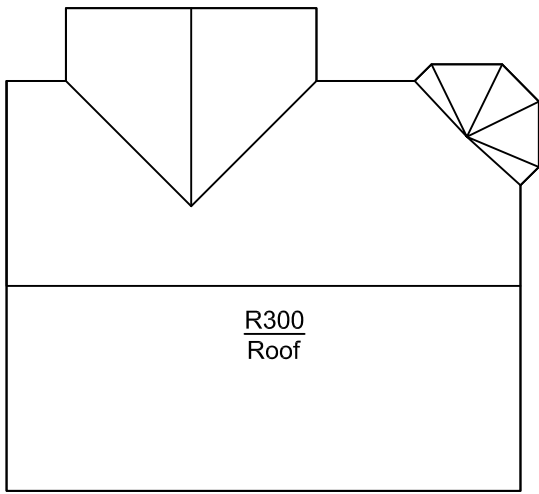

# STANDARD SPACE REPORT

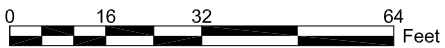

## HARDER HOUSE

### Roof Plan

1604 SW Tenth Avenue, Portland, Oregon 97201

Print Date: 10/2010

Last Modified Date: 10/2010



Portland State  
UNIVERSITY

Campus Planning Office  
<http://www.pdx.edu/planning-sustainability>