

STANDARD LAYER REPORT		
	AREA	QTY
Building Services	837	10
Circulation	2,697	16
Net Assignable Space	8,003	28
Vertical Penetrations	59	8
TOTAL:	11,596	62
Floor Gross:	13,248	

STANDARD SPACE REPORT

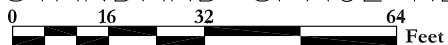

HELEN GORDON CHILD DEVELOPMENT CENTER

First Floor Plan

1609 SW Twelfth Avenue, Portland, Oregon 97201



Print Date:

Last Modified Date: 09/2023

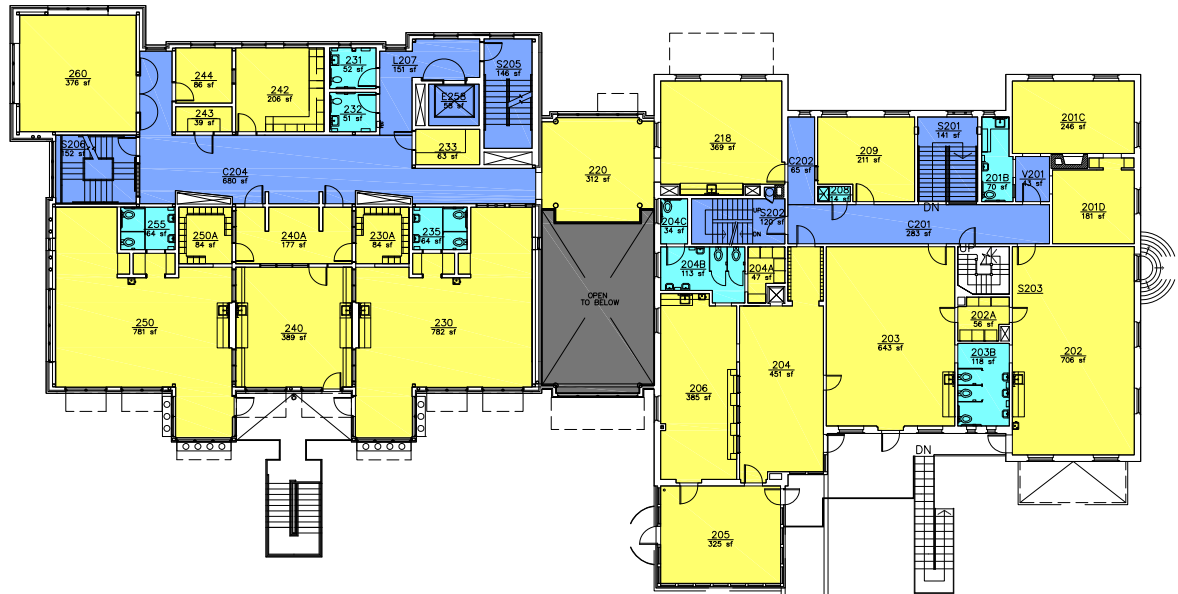

Capital Projects & Construction
<http://www.pdx.edu/construction>

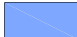

STANDARD LAYER REPORT			
		AREA	QTY
	Building Services	580	9
	Circulation	1,839	10
	Net Assignable Space	6,999	23
	Open To Below	533	1
TOTAL:		9,951	43
Floor Gross:		10,975	

STANDARD SPACE REPORT

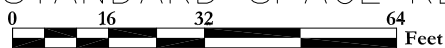

HELEN GORDON CHILD DEVELOPMENT CENTER

Second Floor Plan

1609 SW Twelfth Avenue, Portland, Oregon 97201





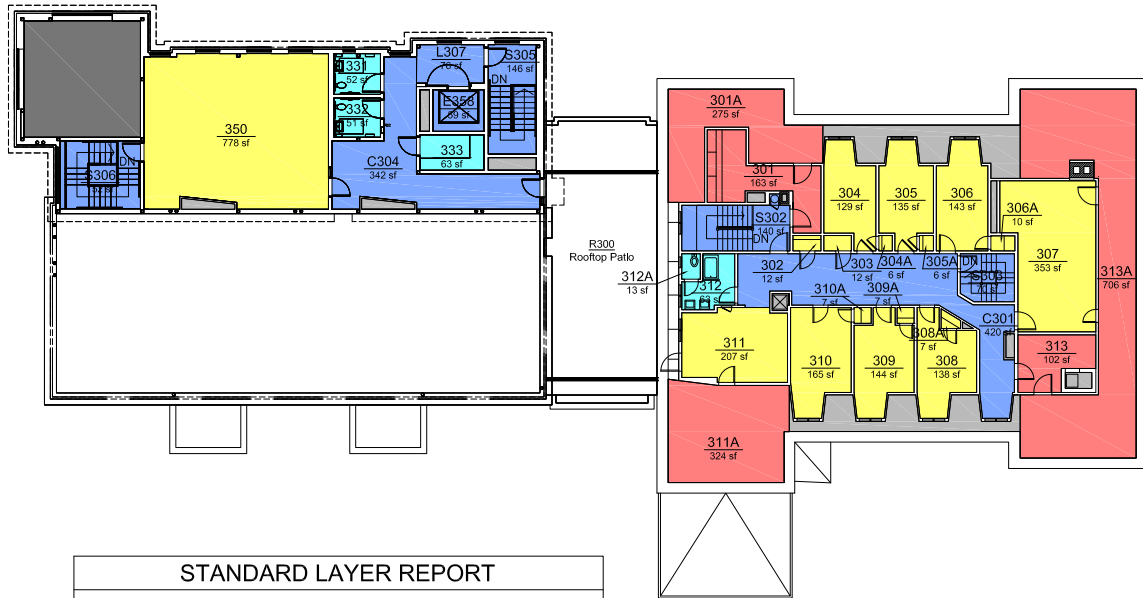

Print Date:

Last Modified Date: 05/2016

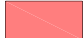

Campus Planning Office
<http://www.pdx.edu/campus-planning>



STANDARD LAYER REPORT		
	AREA	QTY
	Building Services	242 5
	Circulation	1,405 8
	Mechanical Space	1,570 5
	Net Assignable Space	2,259 17
	Open To Below	376 1
	Vertical Penetrations	398 15
	TOTAL:	6,250 51
	Floor Gross:	6,532

STANDARD SPACE REPORT

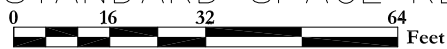

HELEN GORDON CHILD DEVELOPMENT CENTER

Third Floor Plan

1609 SW Twelfth Avenue, Portland, Oregon 97201

Print Date:

Last Modified Date: 04/2016



Portland State
UNIVERSITY

Campus Planning Office
<http://www.pdx.edu/campus-planning>

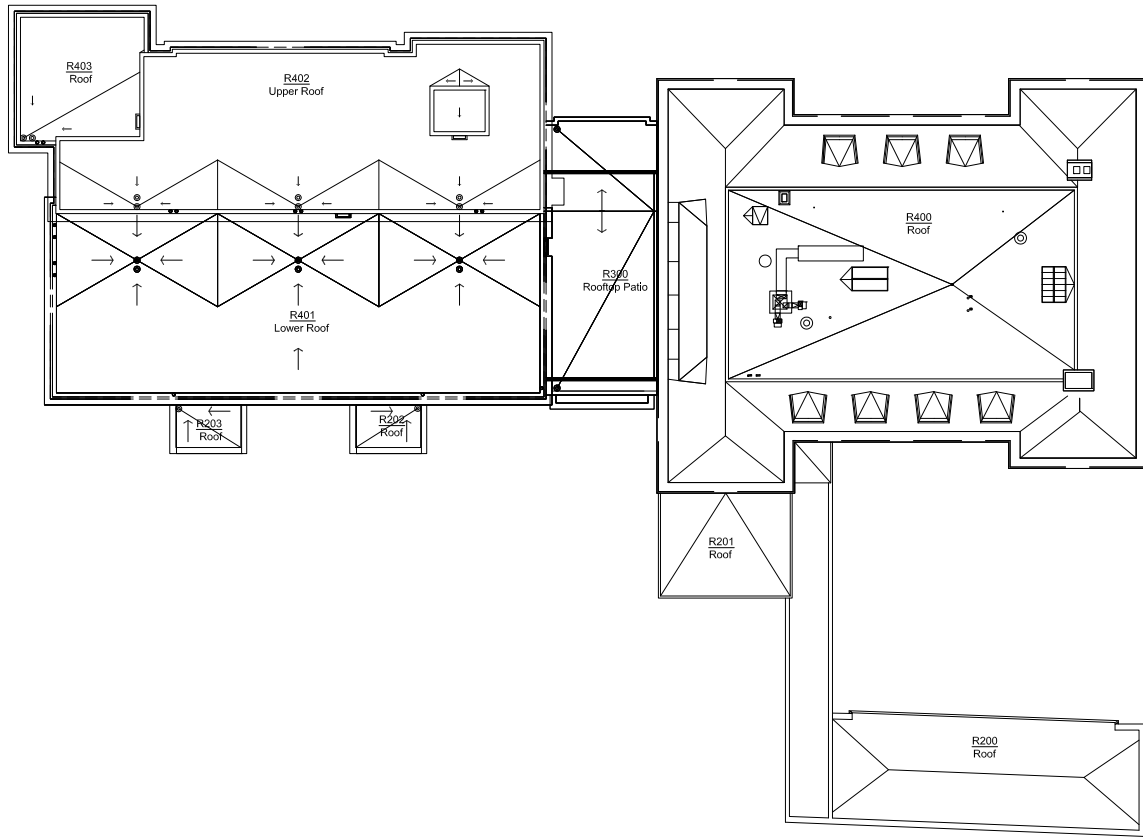

BASE FLOOR PLAN
 0 16 32 64 Feet



HELEN GORDON CHILD DEVELOPMENT CENTER

Roof Plan

1609 SW Twelfth Avenue, Portland, Oregon 97201

Print Date:

Last Modified Date: 04/2016